

SPACE LIST

Southwestern Community College
Math and Science Building
Job No. 2001

SPACE LIST
June 1, 2014 REV

	Space Name	Area (A.S.F.)	No.	Program Area (S.F.)	RFP	Program - RFP difference
A	LIFE SCIENCE					
1	Laboratory Type A: General Biology, Botany, Anatomy & Flex shared	1,617	5	8,085		
2	Laboratory Type B: Anatomy & Physiology	1,617	1	1,617		
3	Laboratory Type C: Cellular & Molecular Biology, Biotechnology, Physiology	1,617	1	1,617		
4	Laboratory Type D: Zoology	1,617	1	1,617		
5	Laboratory Type E: Microbiology	1,617	1	1,617		
6	Anatomy/Physiology Prep/Stock	529	1	529		
7	General Biology Prep/Stock	529	1	529		
8	Microbiology Prep/Stock	529	1	529		
9	Molecular Biology Prep/Stock	529	1	529		
10	Prep/Stock Office	150	2	300		
11	Advanced Studies Laboratory	483	1	483		
12	Cadaver Room	427	1	427		
13	Live Animal Room	154	1	154		
14	Dead Animal Room	154	1	154		
15	Tissue Culture Room	154	1	154		
16	Specimen Store Room	154	1	154		
17	Autoclave Room	154	1	154		
18	Chemical Store Room	156	1	156		
19	Greenhouse	361	1	361		
20	BioPond - not calculated in interior program area 361 SF					
	Sub-Total			19,166		
	RFP PROGRAM BLOCK A LIFE SCIENCE/BIOLOGY				16,900	4,033
B	PHYSICAL SCIENCES					
1	Laboratory Type F: Astronomy/Physics/ Geology/Geography	1,617	2	3,234		
2	Laboratory Type G: General Chemistry	1,617	3	4,851		
3	Laboratory Type H: Organic Chemistry	1,617	1	1,617		
4	Chemistry Prep/Stock	1,081	1	1,081		
5	Physics/Astronomy Prep/Stock	741	1	741		
6	Geology/Geography Prep/Stock	261	1	261		
7	Prep/Stock Offices	150	2	300		
8	Advanced Studies Laboratory	483	1	483		
9	Instrument / NMR Room	897	1	897		
10	Balance Room	456	1	456		
11	Chemical Store Room	456	1	456		
12	Telescope Storage	154	1	154		
13	Astronomy Viewing Platform	0	0	0		
	Sub-Total			14,531		
	RFP PROGRAM BLOCK B PHYSICAL SCIENCES				16,800	367
C	LECTURE					
1	Classroom A	2,150	1	2,150		
2	Classroom B	1,600	1	1,600		
3	Classroom C	977	3	2,931		
4	Classroom D	977	13	12,701		
5	Computer classroom	1,000	3	3,000		
	Sub-Total			22,382		
	RFP PROGRAM BLOCK C MATHEMATICS LECTURE				17,600	4,159
D	MATH LAB					
1	Tutor Counter	240	1	240		
2	Open Study	800	2	1,600		
3	Open Computer	1,000	1	1,000		
4	Group Study - Small	100	4	400		
5	Group Study - Large	450	1	450		
6	Office/Storage	450	1	450		
7	MESA: director off, clerical, open work/study, 8 seat conf rm	1300	1	1300		
	Sub-Total			5,440		
	RFP PROGRAM BLOCK D MATHEMATICS LAB				2,000	3,440
E	FACULTY OFFICE & MEETING ROOMS					
1	Faculty Office	90	45	4,050		
	Sub-Total			4,050		
	RFP PROGRAM BLOCK E SUPPORT SERVICES: FACULTY OFFICE, MEETING ROOMS				3,420	630
F	ADMINISTRATIVE OFFICE & SCHOOL SUPPORT					
1	Dean's Office	300	1	300		
2	Reception/Waiting/Copy/Mail	500	1	500		
3	Storage	250	1	250		
4	Faculty Work	350	1	350		
	Sub-Total			1,400		
	RFP PROGRAM BLOCK F ADMINISTRATIVE OFFICE & SCHOOL SUPPORT				1,500	-100
G	OTHER: TECHNICIAN OFFICE, LOUNGE , ETC					
	INCLUDED IN AREAS A & B	0	0	0		
	Sub-Total			0		
	RFP PROGRAM BLOCK G OTHER: TECHNICIAN OFFICE, LOUNGE, ETC				500	-500
	TOTAL NET S.F.			66,969	58,720	12,029
	TOTAL GROSS S.F. @ 65% EFF			103,029	59,720	11,029
	RFP GROSS S.F. @ 65% EFF			91,877		
	GROSS SF AREA OVER RFP			11,152		

Area Name - Laboratory Type A

Space Number - A1

ASF - 1,617 (Face of Wall)

Date - June 09 2014

No. Required - 5

Information received from - Life Science Faculty

General Description - Life Science Instructional Laboratory for General Biology, Botany, Anatomy, & Flex Lab (shared)
Number of Students: 32

Adjacencies - Direct access to prep/stock room
Near other life science labs
Anatomy lab directly adjacent to Cadaver Room

Architecture - Occupancy: B
Planning dimensions: 34'x50' (centerline of wall)
Floor: sealed concrete or VCT
Walls: gypsum board with enamel paint
Ceiling: acoustic tile at 10'
Doors: 36x80 with window at corridor; 36x80 dutch door at prep room
Natural daylight: exterior windows with light attenuation
Acoustic attenuation: NC 40 or less
Security: Card key or punch key access

Mechanical - Temperature: 72 deg F +/- 2 deg F
Humidity: ambient
Exhaust: 100% (VAV)
Air change rate: 6/hour occupied; 2 per hour unoccupied
Equipment heat gain: 25 btuh/sf
Manual control to increase air change rate to 12 air changes per hour on demand for 2 labs
Low exhaust at perimeter in addition to exhaust at ceiling for 2 labs

Structural - Vibration attenuation: 4,000 microinches per second or less as defined by AISC #11

Plumbing - Hot/Cold water at sinks
Pure water at sinks
Domestic water at safety shower/eyewash
Drain at eyewash
Floor drain at safety shower
Emer gas shut-off

Electrical - 115v outlets at all benches
(1) duplex at each student station
Fourplex at 4' on center at perimeter
Standby power at equipment space
Wired and wireless data
Lighting: direct/indirect at 500 Lux with dimmer switch

Contractor Furnished Equipment - Wood casework (bamboo veneer over plywood/MDF substrate)
Epoxy tops and sinks (dark green epoxy tops)
Faucets and fittings (satin chrome)
Mobile lab benches
Marker boards- vertical sliding
Fire ext. cabinet

College Furnished Equipment - Chairs, stools
Benchtop analytical instruments
Scientific equipment
Projection system
Wall charts

Illustration - Laboratory Type A
General Biology, Botany, Anatomy, Flex Lab (shared)
(5) labs

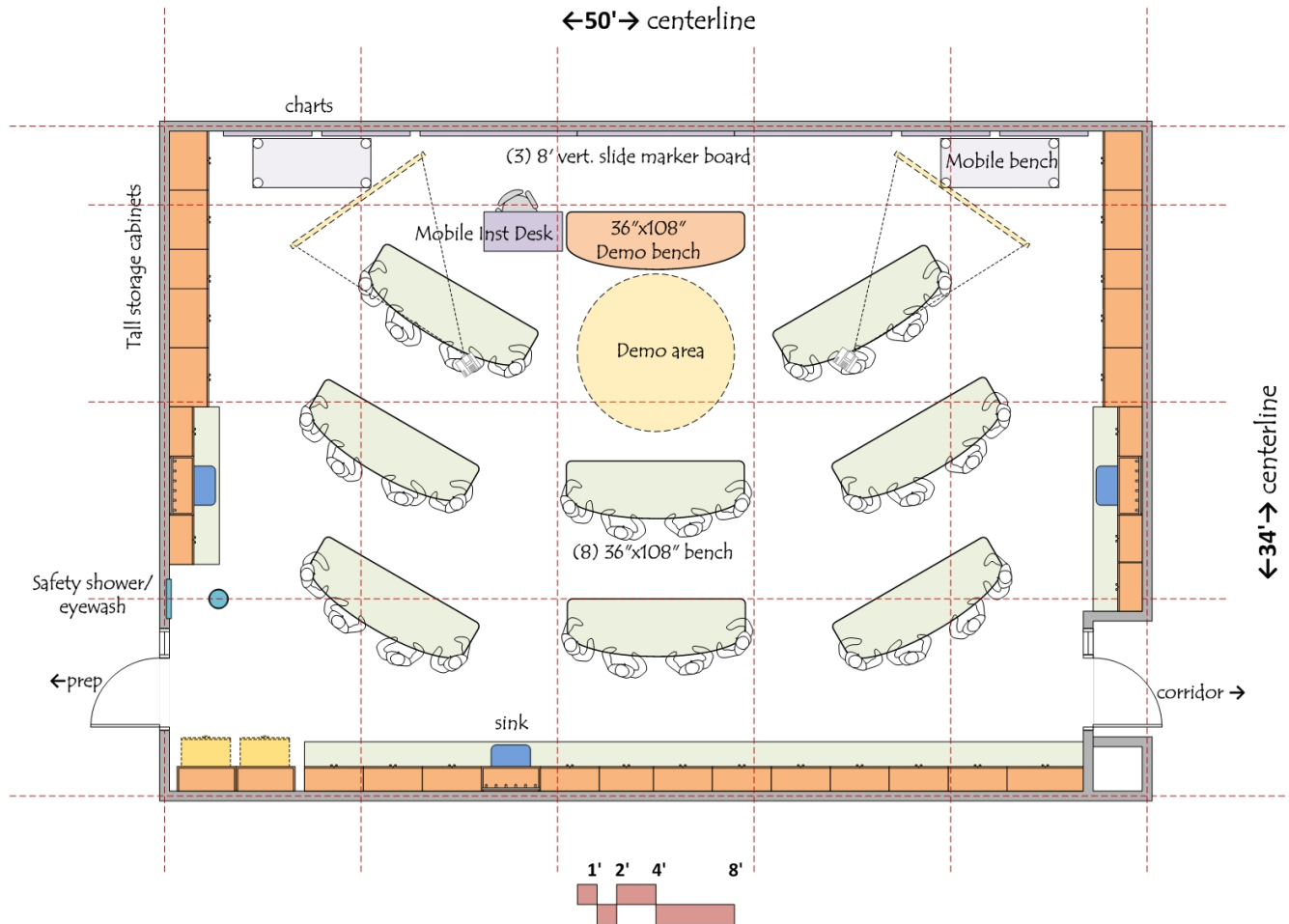
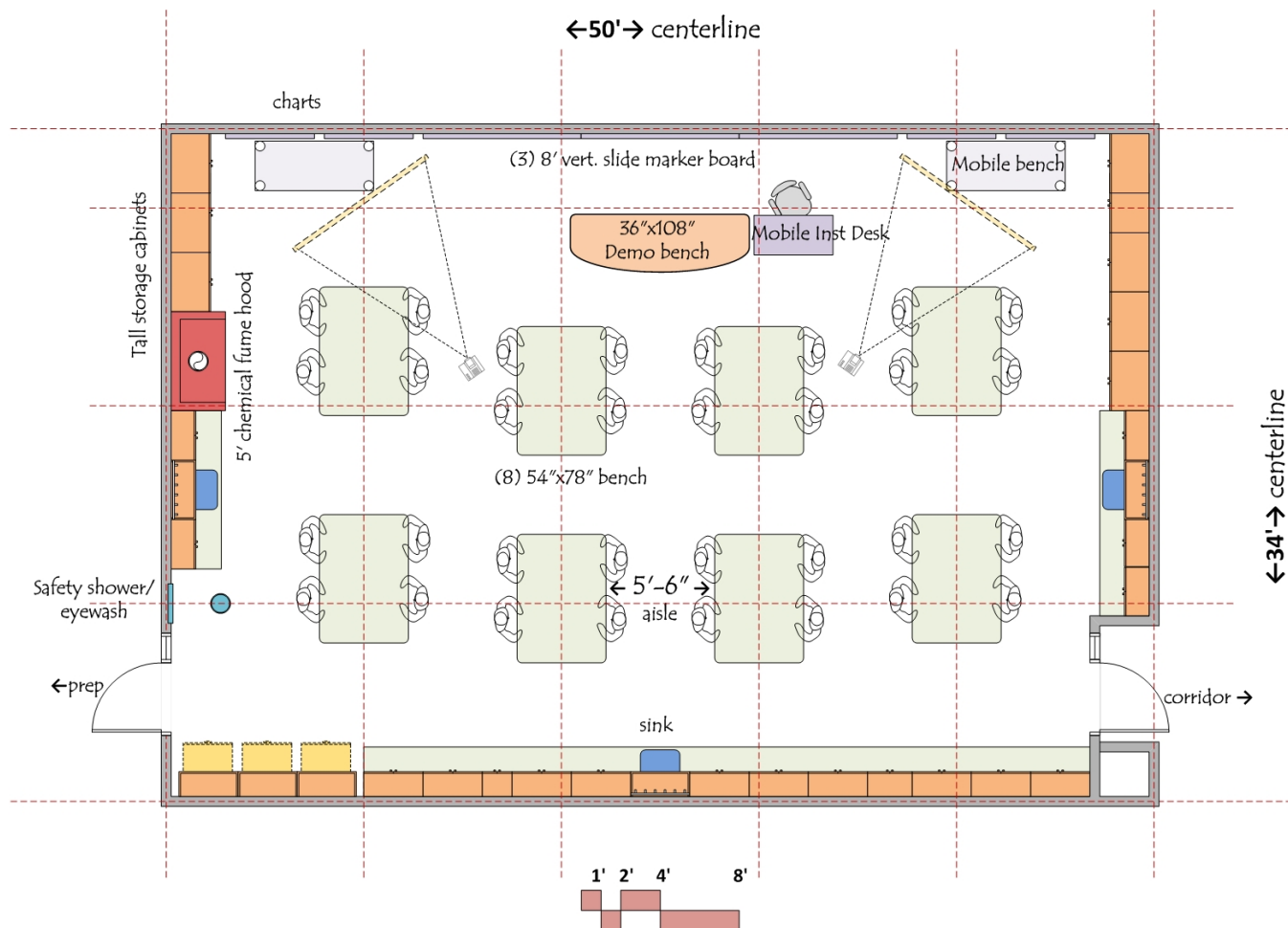

Illustration - Laboratory Type A
General Biology, Botany, Anatomy, Flex Lab (shared)
 Consider short island scheme in lieu of chevron scheme for 1 or more labs



Area Name - Laboratory Type B

Space Number - A2

ASF - 1,617 (Face of Wall)

Date - June 09, 2014

No. Required - 1

Information received from - Life Science Faculty

General Description - Life Science Instructional Laboratory for Anatomy & Physiology
Number of Students: 32

Adjacencies - Direct access to prep/stock room
Near other life science labs

Architecture - Occupancy: B
Planning dimensions: 34'x50' (centerline of wall)
Floor: sealed concrete or VCT
Walls: gypsum board with enamel paint
Ceiling: acoustic tile at 10'
Doors: 36x80 with window at corridor; 36x80 dutch door at prep room
Natural daylight: exterior windows with light attenuation
Acoustic attenuation: NC 40 or less
Security: Card key or punch key access

Mechanical - Temperature: 72 deg F +/- 2 deg F
Humidity: ambient
Exhaust: 100% (VAV)
Air change rate: 6/hour occupied;
4 per hour unoccupied
Equipment heat gain: 25 btuh/sf
5' Chemical Fume Hood: 600 c.f.m. (VAV)
Manual control to increase air change rate to 12 air changes per hour
on demand for 2 labs
Low exhaust at perimeter in addition to exhaust at ceiling for 2 labs

Structural - Vibration attenuation: 4,000 microinches per second or less as defined by AISC #11

Plumbing - Hot/Cold water at sinks
Pure water at sinks
Natural gas at each student station
Domestic water at safety shower/eyewash
Drain at eyewash
Floor drain at safety shower
Emer gas shut-off

Electrical - 115v outlets at all benches
(1) duplex at each student station
Fourplex at 4' on center at perimeter
Standby power at equipment space
Wired and wireless data
Lighting: direct/indirect at 500 Lux with dimmer switch

Contractor Furnished Equipment - Wood casework (bamboo veneer over plywood/MDF substrate)
Epoxy tops and sinks (dark green epoxy tops)
Faucets and fittings (satin chrome)
Chemical fume hood
Mobile lab benches
Marker boards- vertical sliding
Fire ext. cabinet

College Furnished Equipment - Chairs, stools
Benchtop analytical instruments
Scientific equipment
Projection system
Wall charts

Illustration - Laboratory Type B
Anatomy & Physiology
(1) Labs

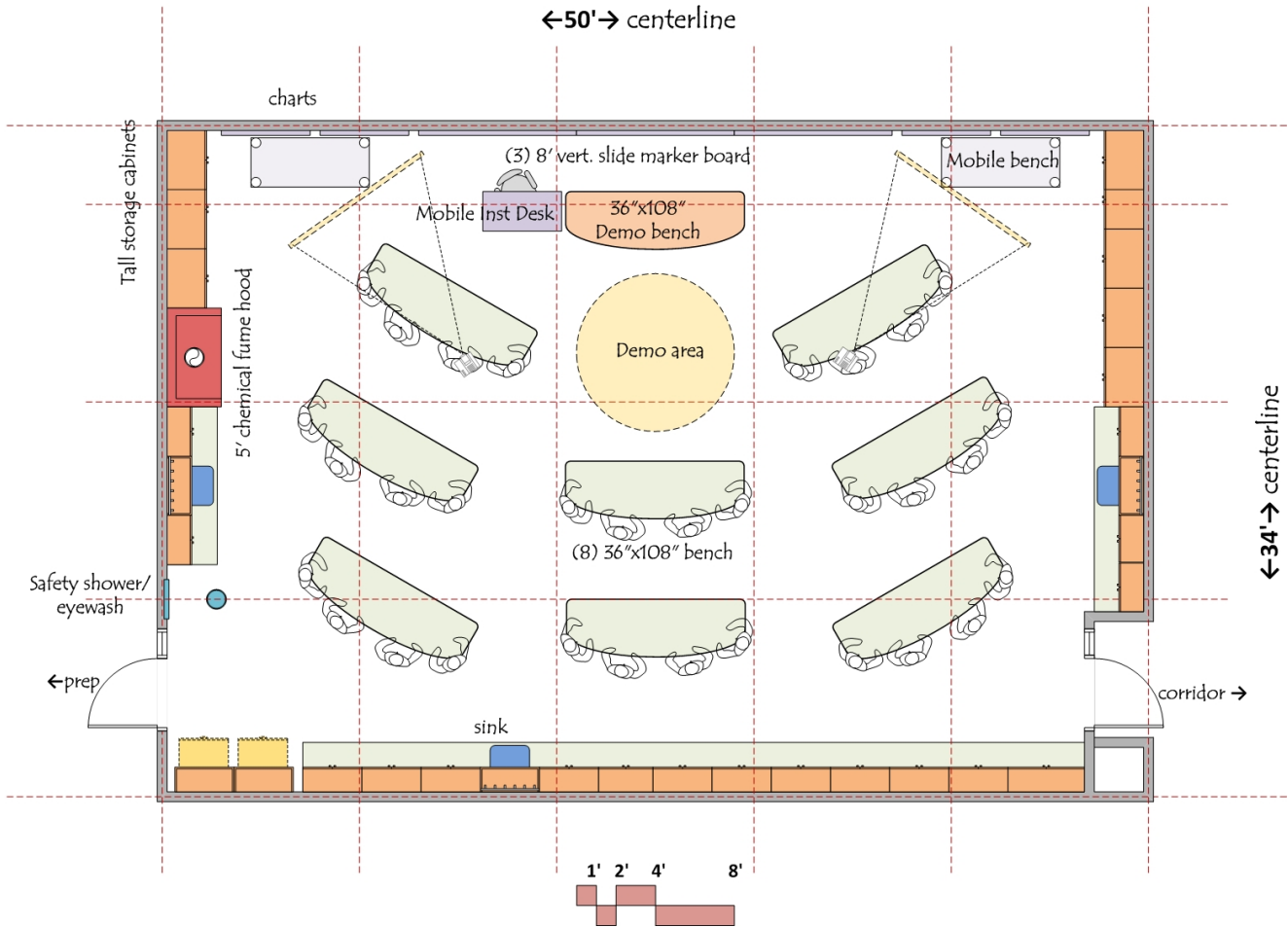

Area Name - Laboratory Type C

Space Number - A3

ASF - 1,617 (Face of Wall)

Date - June 09, 2014

No. Required - 1

Information received from - Life Science Faculty

General Description - Life Science Instructional Laboratory for Cellular & Molecular Biology; Biotechnology; Physiology
Number of Students: 32

Adjacencies - Direct access to prep/stock room
Near other life science labs

Architecture - Occupancy: B
Planning dimensions: 34'x50' (centerline of wall)
Floor: sealed concrete or VCT
Walls: gypsum board with enamel paint
Ceiling: acoustic tile at 10'
Doors: 36x80 with window at corridor; 36x80 dutch door at prep room
Natural daylight: exterior windows with light attenuation
Acoustic attenuation: NC 40 or less
Security: Card key or punch key access

Mechanical - Temperature: 72 deg F +/- 2 deg F
Humidity: ambient
Exhaust: 100% (VAV)
Air change rate: 6/hour occupied;
4 per hour unoccupied
Equipment heat gain: 25 btuh/sf
5' Chemical Fume Hood: 600 c.f.m. (VAV)

Structural - Vibration attenuation: 4,000 microinches per second or less as defined by AISC #11

Plumbing - Hot/Cold water at sinks
Pure water at sinks
Natural gas at each student station
Vacuum at each student station
Domestic water at safety shower/eyewash
Drain at eyewash
Floor drain at safety shower
Emer gas shut-off

Electrical - 115v outlets at all benches
(1) duplex at each student station
Fourplex at 4' on center at perimeter
Standby power at equipment space
Wired and wireless data
Lighting: direct/indirect at 500 Lux with dimmer switch

Contractor Furnished Equipment - Wood casework (bamboo veneer over plywood/MDF substrate)
Epoxy tops and sinks (dark green epoxy tops)
Faucets and fittings (satin chrome)
Chemical fume hood
Mobile lab benches
Marker boards- vertical sliding
Fire ext. cabinet

College Furnished Equipment - Chairs, stools
Benchtop analytical instruments
Scientific equipment
Projection system
Wall charts

Illustration - Laboratory Type C
Cellular & Molecular Biology, Biotechnology, Physiology
(1) Lab

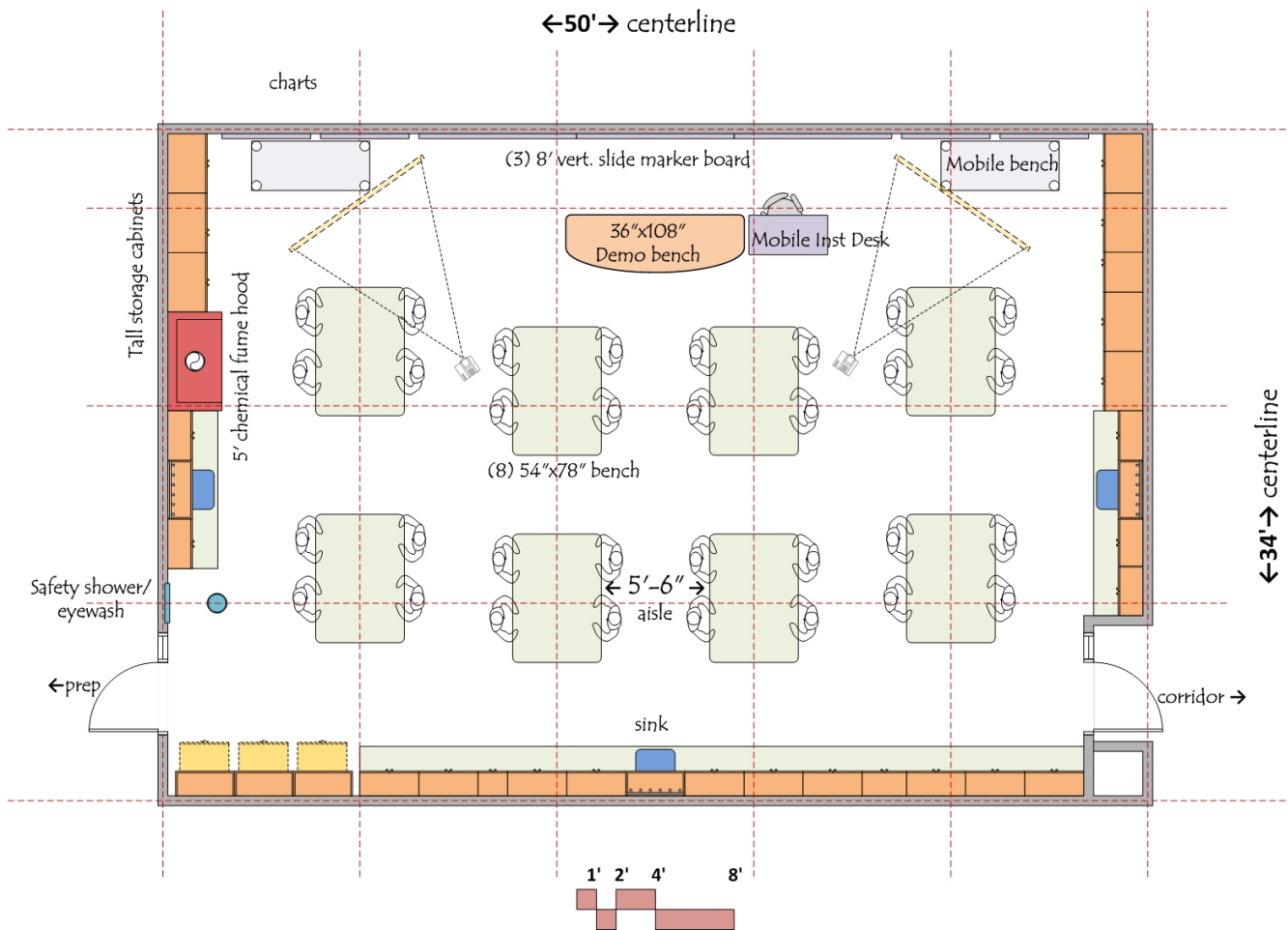

Area Name - Laboratory Type D

Space Number - A4

ASF - 1,617 (Face of Wall)

Date - June 09, 2014

No. Required - 1

Information received from - Life Science Faculty

General Description - Life Science Instructional Laboratory for Zoology
Number of Students: 32

Adjacencies - Direct access to prep/stock room
Near other life science labs

Architecture - Occupancy: B
Planning dimensions: 34'x50' (centerline of wall)
Floor: sealed concrete or VCT
Walls: gypsum board with enamel paint
Ceiling: acoustic tile at 10'
Doors: 36x80 with window at corridor; 36x80 dutch door at prep room
Natural daylight: exterior windows with light attenuation
Acoustic attenuation: NC 40 or less
Security: Card key or punch key access

Mechanical - Temperature: 72 deg F +/- 2 deg F
Humidity: ambient
Exhaust: 100% (VAV)
Air change rate: 6/hour occupied;
2 per hour unoccupied
Equipment heat gain: 25 btuh/sf
Manual control to increase air change rate to 12 air changes per hour on demand (shark dissection)
Low exhaust at perimeter in addition to exhaust at ceiling

Structural - Vibration attenuation: 4,000 microinches per second or less as defined by AISC #11

Plumbing - Hot/Cold water at sinks
Pure water at sinks
Domestic water at safety shower/eyewash
Drain at eyewash
Floor drain at safety shower
Emer gas shut-off

Electrical - 115v outlets at all benches
(1) duplex at each student station
Fourplex at 4' on center at perimeter
Standby power at equipment space
Wired and wireless data
Lighting: direct/indirect at 500 Lux with dimmer switch

Contractor Furnished Equipment - Wood casework (bamboo veneer over plywood/MDF substrate)
Epoxy tops and sinks (dark green epoxy tops)
Faucets and fittings (satin chrome)
Mobile lab benches
Marker boards- vertical sliding
Fire ext. cabinet

College Furnished Equipment - Chairs, stools
Benchtop analytical instruments
Scientific equipment
Projection system
Wall charts

Illustration - Laboratory Type D
Zoology
(1) Lab

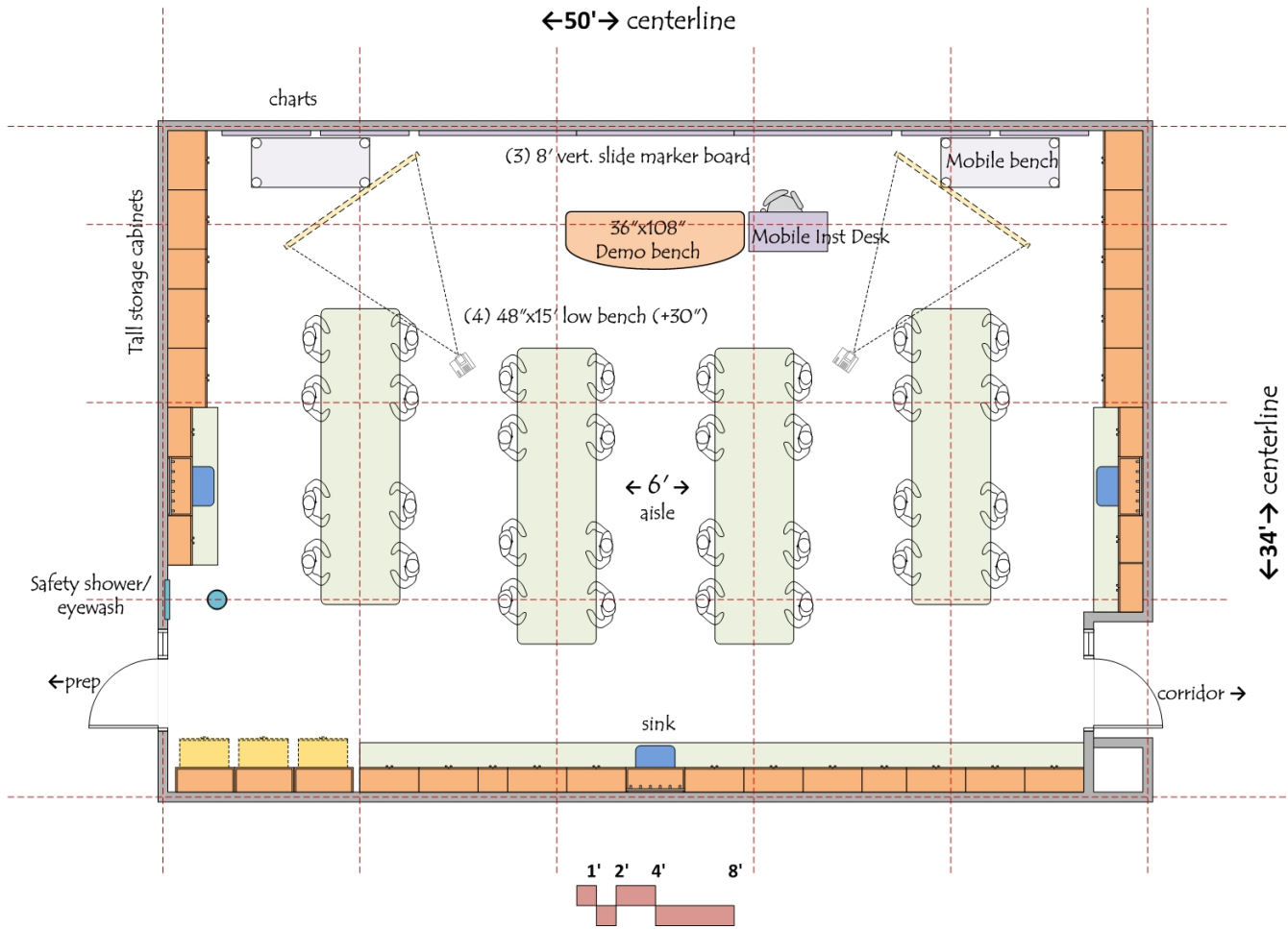

Area Name - Laboratory Type E

Space Number - A5

ASF - 1,617 (Face of Wall)

Date - June 09, 2014

No. Required - 1

Information received from - Life Science Faculty

General Description - Life Science Instructional Laboratory for Microbiology
Number of Students: 24

Adjacencies - Direct access to prep/stock room
Near other life science labs

Architecture - Occupancy: B
Planning dimensions: 34'x50' (centerline of wall)
Floor: sealed concrete or VCT
Walls: gypsum board with enamel paint
Ceiling: acoustic tile at 10'
Doors: 36x80 with window at corridor; 36x80 dutch door at prep room
Natural daylight: exterior windows with light attenuation
Acoustic attenuation: NC 40 or less
Security: Card key or punch key access

Mechanical - Temperature: 72 deg F +/- 2 deg F
Humidity: ambient
Exhaust: 100% (VAV)
Air change rate: 6/hour occupied;
4 per hour unoccupied
Equipment heat gain: 25 btuh/sf
5' Chemical Fume Hood: 600 c.f.m. (VAV)
Manual control to increase air change rate to 12 air changes per hour
on demand (shark dissection)
Low exhaust at perimeter in addition to exhaust at ceiling

Structural - Vibration attenuation: 2,000 microinches per second or less as defined by AISC #11

Plumbing - Hot/Cold water at sinks
Pure water at sinks
Domestic water at safety shower/eyewash
Natural gas at each student station
Vacuum at each student station
Drain at eyewash
Floor drain at safety shower
Emer gas shut-off

Electrical - 115v outlets at all benches
(1) duplex at each student station
Fourplex at 4' on center at perimeter
Standby power at equipment space
Wired and wireless data
Lighting: direct/indirect at 500 Lux with dimmer switch

Contractor Furnished Equipment - Wood casework (bamboo veneer over plywood/MDF substrate)
Epoxy tops and sinks (dark green epoxy tops)
Faucets and fittings (satin chrome)
Chemical fume hood
Mobile lab benches
Marker boards- vertical sliding
Fire ext. cabinet

College Furnished Equipment - Chairs, stools
Benchtop analytical instruments
Scientific equipment
Projection system
Wall charts

Illustration - Laboratory Type E
Microbiology
(1) Lab

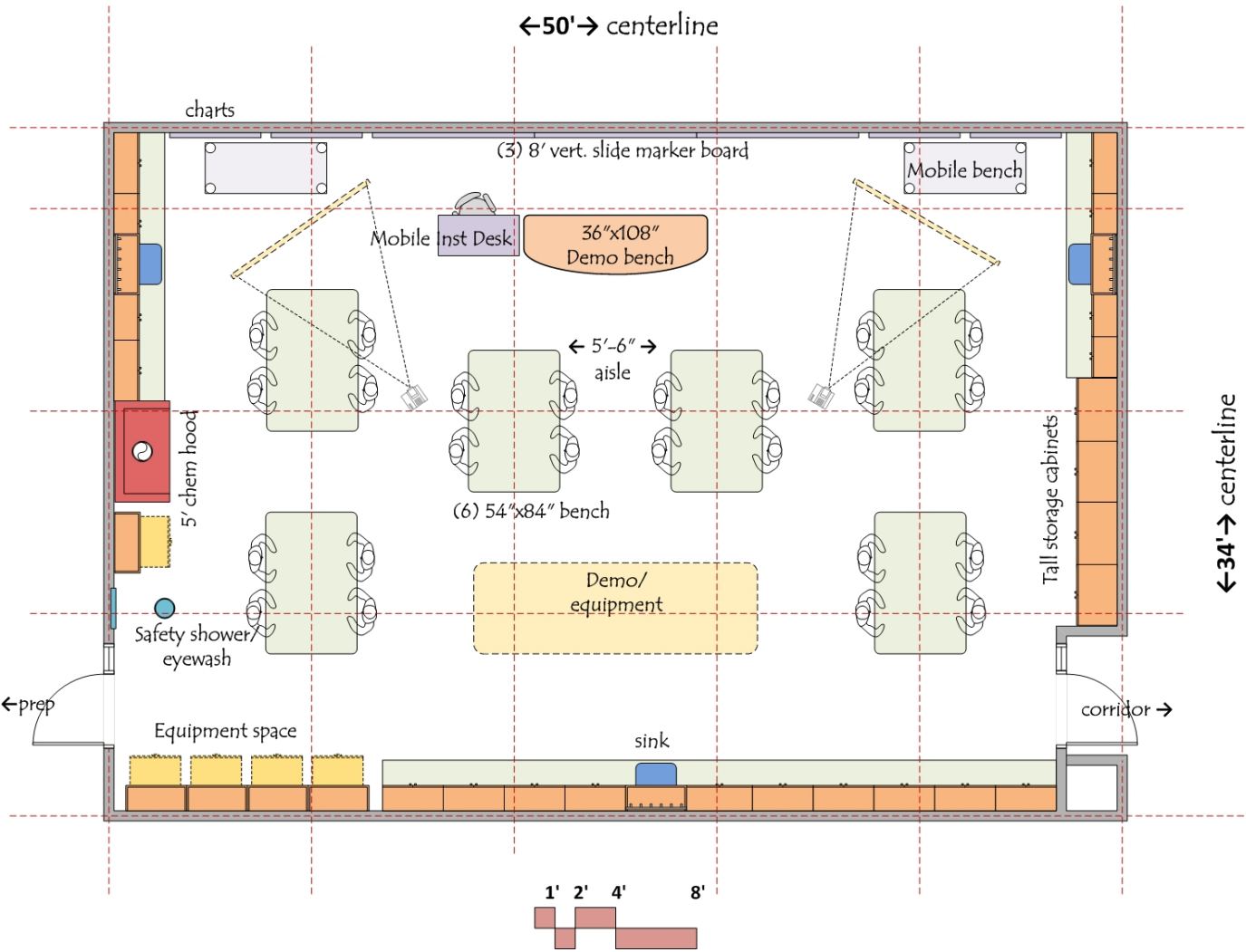

Area Name - Anatomy & Physiology Prep/Stock

Space Number - A6

ASF - 529 (face of wall)

Date - June 09, 2014

No. Required - 1

Information received from - Life Science Faculty

General Description - Prep and storage for anatomy & physiology labs
May be combined with other life science prep/stock rooms

Adjacencies - Direct access to anatomy & physiology labs

Architecture - Occupancy: B
Planning dimensions: 24'x24' (centerline of wall)
Floor: sealed concrete or VCT
Walls: gypsum board with enamel paint
Ceiling: acoustic tile at 9' minimum
Doors: 36x80 with window at corridor; 36x80 dutch door at prep room
Natural daylight: exterior windows with light attenuation
Acoustic attenuation: NC 40 or less
Security: Card key or punch key access

Mechanical - Temperature: 72 deg F +/- 2 deg F
Humidity: ambient
Exhaust: 100% (VAV)
Air change rate: 6/hour occupied;
4 per hour unoccupied
Equipment heat gain: 50 btuh/sf
5' Chemical Fume Hood: 600 c.f.m. (VAV)

Structural - Vibration attenuation: 4,000 microinches per second or less as defined by AISC #11

Plumbing - Hot/Cold water at sinks
Pure water at sinks
Domestic water at safety shower/eyewash
Natural gas, vacuum at lab benches
Drain at eyewash
Floor drain at safety shower
Emer gas shut-off

Electrical - 115v outlets at all benches
Fourplex at 4' on center at perimeter
Standby power at equipment space
Wired and wireless data
Lighting: direct/indirect at 500 Lux

Contractor Furnished Equipment - Wood casework (bamboo veneer over plywood/MDF substrate)
Epoxy tops and sinks (black epoxy tops)
Faucets and fittings (satin chrome)
Chemical fume hood
Mobile lab benches
Fire ext. cabinet

College Furnished Equipment - Chairs, stools
Benchtop analytical instruments
Scientific equipment

Illustration - Anatomy & Physiology Prep/Stock

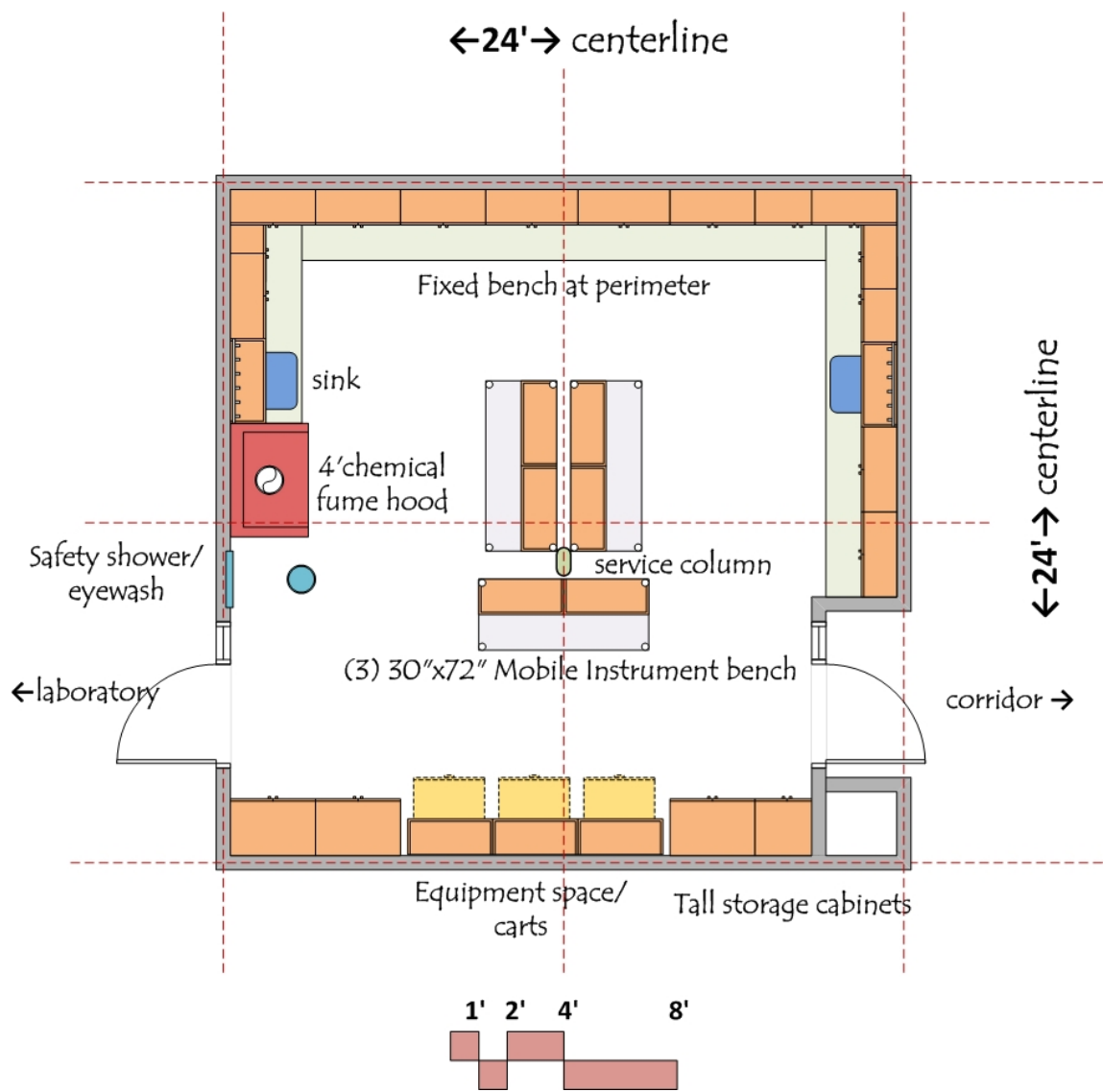

Area Name - General Biology Prep/Stock

Space Number - A7

ASF - 529 (face of wall)

Date - June 09, 2014

No. Required - 1

Information received from - Life Science Faculty

General Description - Prep and storage for general biology labs
May be combined with other life science prep/stock rooms

Adjacencies - Direct access to general biology labs

Architecture - Occupancy: B
Planning dimensions: 24'x24' (centerline of wall)
Floor: sealed concrete or VCT
Walls: gypsum board with enamel paint
Ceiling: acoustic tile at 9' minimum
Doors: 36x80 with window at corridor; 36x80 dutch door at prep room
Natural daylight: exterior windows with light attenuation
Acoustic attenuation: NC 40 or less
Security: Card key or punch key access

Mechanical - Temperature: 72 deg F +/- 2 deg F
Humidity: ambient
Exhaust: 100% (VAV)
Air change rate: 6/hour occupied;
4 per hour unoccupied
Equipment heat gain: 50 btuh/sf
5' Chemical Fume Hood: 600 c.f.m. (VAV)

Structural - Vibration attenuation: 4,000 microinches per second or less as defined by AISC #11

Plumbing - Hot/Cold water at sinks
Pure water at sinks
Domestic water at safety shower/eyewash
Natural gas, vacuum at lab benches
Drain at eyewash
Floor drain at safety shower
Emer gas shut-off

Electrical - 115v outlets at all benches
Fourplex at 4' on center at perimeter
Standby power at equipment space
Wired and wireless data
Lighting: direct/indirect at 500 Lux

Contractor Furnished Equipment - Wood casework (bamboo veneer over plywood/MDF substrate)
Epoxy tops and sinks (black epoxy tops)
Faucets and fittings (satin chrome)
Chemical fume hood
Mobile lab benches
Undercounter washer
Fire ext. cabinet

College Furnished Equipment - Chairs, stools
Benchtop analytical instruments
Scientific equipment

Illustration - General Biology Prep/Stock

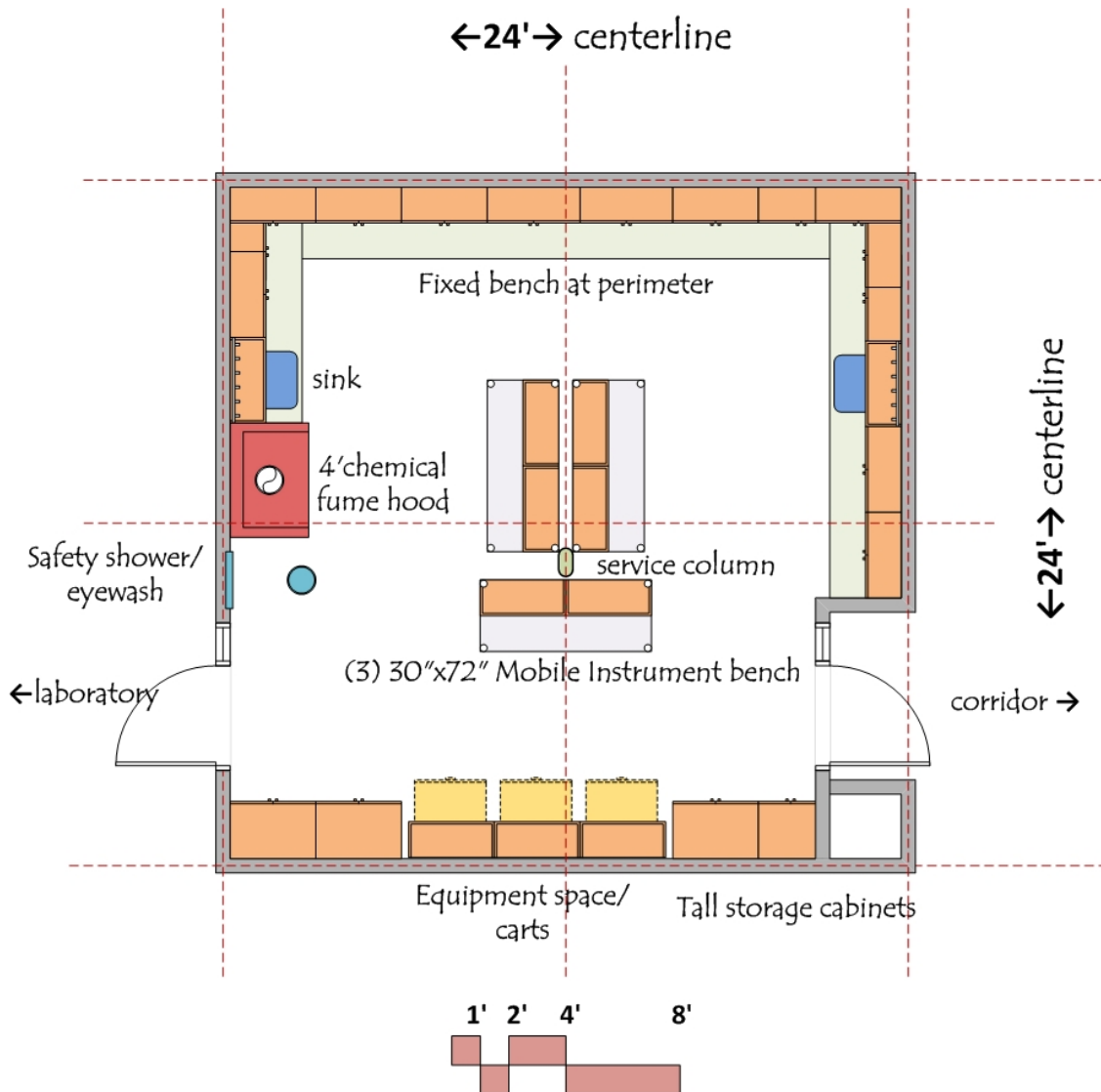

Area Name - Microbiology Prep/Stock

Space Number - A8

ASF - 529 (face of wall)

Date - June 09, 2014

No. Required - 1

Information received from - Life Science Faculty

General Description - Prep and storage for microbiology labs
May be combined with other life science prep/stock rooms

Adjacencies - Direct access microbiology lab

Architecture - Occupancy: B
Planning dimensions: 24'x24' (centerline of wall)
Floor: sealed concrete or VCT
Walls: gypsum board with enamel paint
Ceiling: acoustic tile at 9' minimum
Doors: 36x80 with window at corridor; 36x80 dutch door at prep room
Natural daylight: exterior windows with light attenuation
Acoustic attenuation: NC 40 or less
Security: Card key or punch key access

Mechanical - Temperature: 72 deg F +/- 2 deg F
Humidity: ambient
Exhaust: 100% (VAV)
Air change rate: 6/hour occupied;
4 per hour unoccupied
Equipment heat gain: 50 btuh/sf
4.5' Biological Safety Cabinet: 600 c.f.m. (VAV)

Structural - Vibration attenuation: 4,000 microinches per second or less as defined by AISC #11

Plumbing - Hot/Cold water at sinks
Pure water at sinks
Domestic water at safety shower/eyewash
Natural gas, vacuum at lab benches
Drain at eyewash
Floor drain at safety shower
Emer gas shut-off

Electrical - 115v outlets at all benches
Fourplex at 4' on center at perimeter
Standby power at equipment space
Wired and wireless data
Lighting: direct/indirect at 500 Lux

Contractor Furnished Equipment - Wood casework (bamboo veneer over plywood/MDF substrate)
Epoxy tops and sinks (black epoxy tops)
Faucets and fittings (satin chrome)
Biological Safety Cabinet with thimble exhaust
Chemical Fume Hood
Mobile lab benches
(2) Undercounter washers
Fire ext. cabinet

College Furnished Equipment - Chairs, stools
Benchtop analytical instruments
Scientific equipment

Illustration - Microbiology Prep/Stock

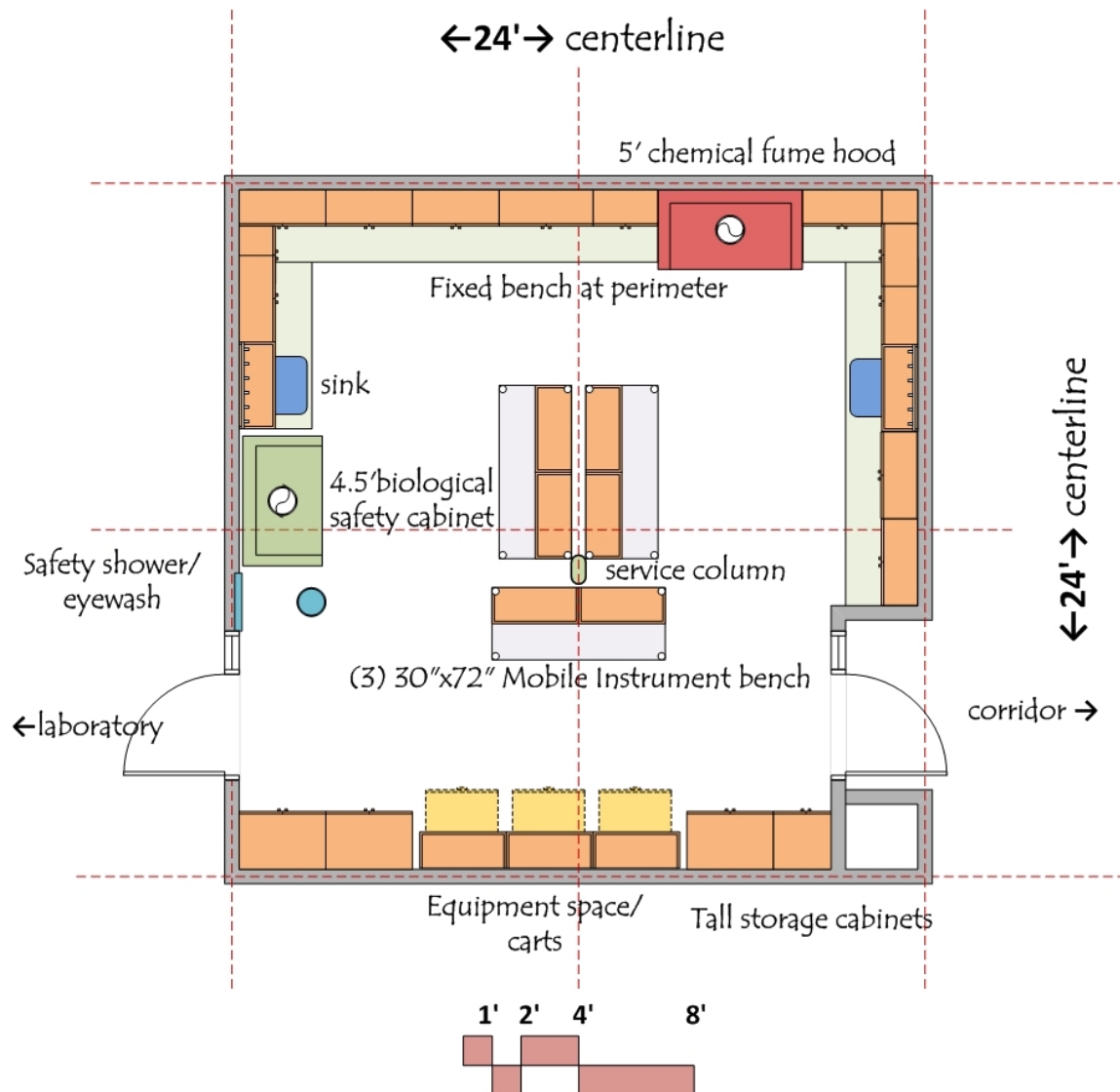

Area Name - Molecular Biology Prep/Stock

Space Number - A9

ASF - 529 (face of wall)

Date - June 09, 2014

No. Required - 1

Information received from - Life Science Faculty

General Description - Prep and storage for molecular biology labs
May be combined with other life science prep/stock rooms

Adjacencies - Direct access molecular biology labs

Architecture - Occupancy: B
Planning dimensions: 24'x24' (centerline of wall)
Floor: sealed concrete or VCT
Walls: gypsum board with enamel paint
Ceiling: acoustic tile at 9' minimum
Doors: 36x80 with window at corridor; 36x80 dutch door at prep room
Natural daylight: exterior windows with light attenuation
Acoustic attenuation: NC 40 or less
Security: Card key or punch key access

Mechanical - Temperature: 72 deg F +/- 2 deg F
Humidity: ambient
Exhaust: 100% (VAV)
Air change rate: 6/hour occupied; 4 per hour unoccupied
Equipment heat gain: 50 btuh/sf
5' Chemical fume hood: 600 c.f.m. (VAV)

Structural - Vibration attenuation: 4,000 microinches per second or less as defined by AISC #11

Plumbing - Hot/Cold water at sinks
Pure water at sinks
Domestic water at safety shower/eyewash
Natural gas, vacuum at lab benches
Drain at eyewash
Floor drain at safety shower
Emer gas shut-off

Electrical - 115v outlets at all benches
Fourplex at 4' on center at perimeter
Standby power at equipment space
Wired and wireless data
Lighting: direct/indirect at 500 Lux

Contractor Furnished Equipment - Wood casework (bamboo veneer over plywood/MDF substrate)
Epoxy tops and sinks (black epoxy tops)
Faucets and fittings (satin chrome)
Chemical fume hood
Mobile lab benches
Undercounter washer
Fire ext. cabinet

College Furnished Equipment - Chairs, stools
Benchtop analytical instruments
Scientific equipment

Illustration - Molecular Biology Prep/Stock

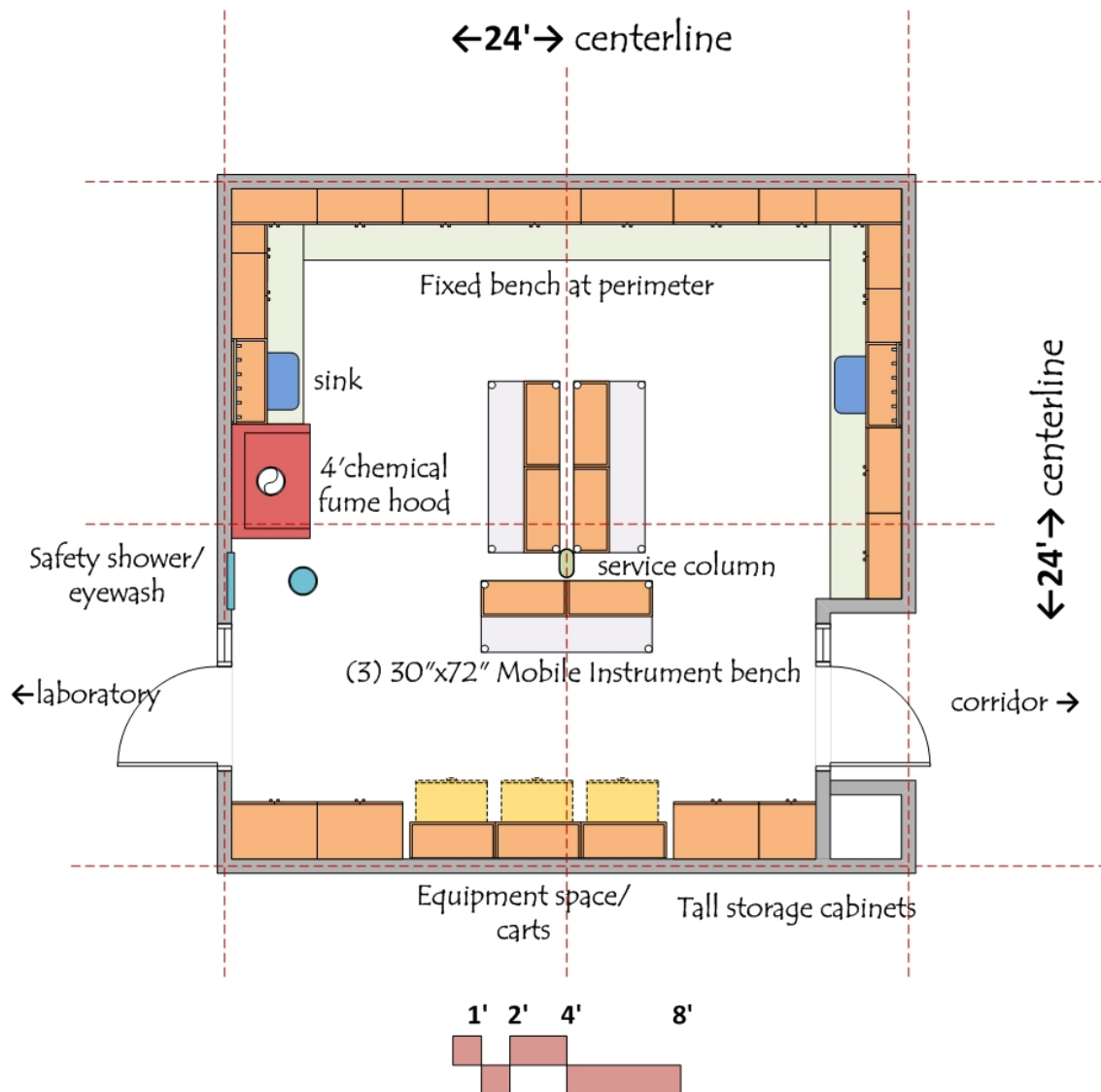

Area Name - Prep/Stock Offices

Space Number - A10

ASF - 150 (face of wall)

Date - June 09, 2014

No. Required - 2

Information received from - Life Science Faculty

General Description - Provides office work space for lab technicians- each office provides shared space for 2 lab technicians

Adjacencies - Direct access to life science prep/stock rooms
Locate within prep/stock

Architecture - Occupancy: B
Planning dimensions: 12'x14' (centerline of wall)
Floor: VCT
Walls: gypsum board with enamel paint
Ceiling: acoustic tile at 9' minimum
Doors: 30x80 with window at corridor;
Natural daylight: exterior windows with light attenuation
Acoustic attenuation: NC 40 or less
Security: Card key or punch key access

Mechanical - Temperature: 72 deg F +/- 2 deg F
Humidity: ambient
Exhaust: 100% (VAV)
Air change rate: 4/hour occupied;
2 per hour unoccupied
Equipment heat gain: 25 btuh/sf

Structural - Vibration attenuation: 4,000 microinches per second or less as defined by AISC #11

Plumbing - None

Electrical - 115v outlets at all benches
Fourplex at 4' on center at perimeter
Wired and wireless data
Lighting: direct/indirect at 400 Lux

**Contractor
Furnished
Equipment** - Wood casework to match labs
Phenolic resin counter top

**College
Furnished
Equipment** - Chairs, stools
Computer

Illustration - Prep/Stock Offices
Locate within Prep/Stock Rooms

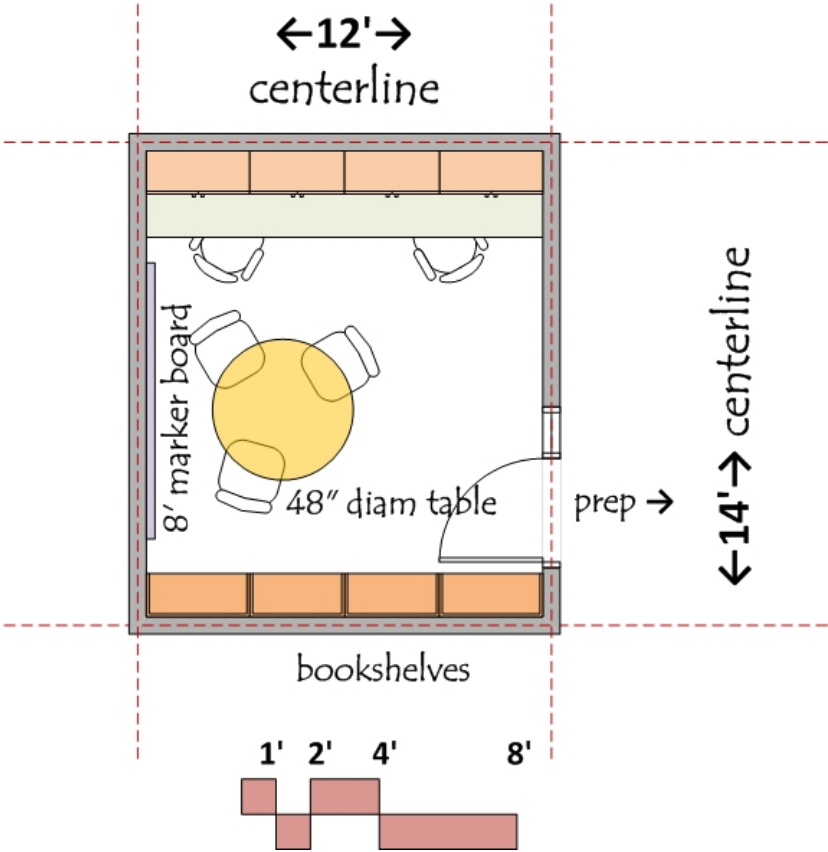

Area Name - Advanced Studies Laboratory

Space Number - A11

ASF - 483 (face of wall)

Date - June 09, 2014

No. Required - 1

Information received from - Life Science Faculty

General Description - Provides research and project work space for life science students and faculty

Adjacencies - Near life science teaching labs
Near life science prep/stock rooms

Architecture - Occupancy: B
Planning dimensions: 22'x24' (centerline of wall)
Floor: sealed concrete or VCT
Walls: gypsum board with enamel paint
Ceiling: acoustic tile at 10' minimum
Doors: 36x80 with window at corridor
Natural daylight: exterior windows with light attenuation
Acoustic attenuation: NC 40 or less
Security: Card key or punch key access

Mechanical - Temperature: 72 deg F +/- 2 deg F
Humidity: ambient
Exhaust: 100% (VAV)
Air change rate: 6/hour occupied;
4 per hour unoccupied
Equipment heat gain: 50 btuh/sf
5' Chemical Fume Hood: 600 c.f.m. (VAV)

Structural - Vibration attenuation: 4,000 microinches per second or less as defined by AISC #11

Plumbing - Hot/Cold water at sinks
Pure water at sinks
Domestic water at safety shower/eyewash
Natural gas, vac, air at benches
Natural gas, vac, air at each fume hood
Drain at eyewash
Floor drain at safety shower
Emer gas shut-off
Argon, He, CO2, cylinder gases

Electrical - 115v outlets at all benches
Fourplex at 4' on center at perimeter
Standby power at equipment space
Wired and wireless data
Lighting: direct/indirect at 500 Lux

Contractor Furnished Equipment - Wood casework (bamboo veneer over plywood/MDF substrate)
Epoxy tops and sinks (black epoxy tops)
Faucets and fittings (satin chrome)
Chemical fume hoods
Mobile lab tables
Fire ext. cabinet

College Furnished Equipment - Chairs, stools
Benchtop analytical instruments
Scientific equipment

Illustration - Advanced Studies Laboratory
Life Science

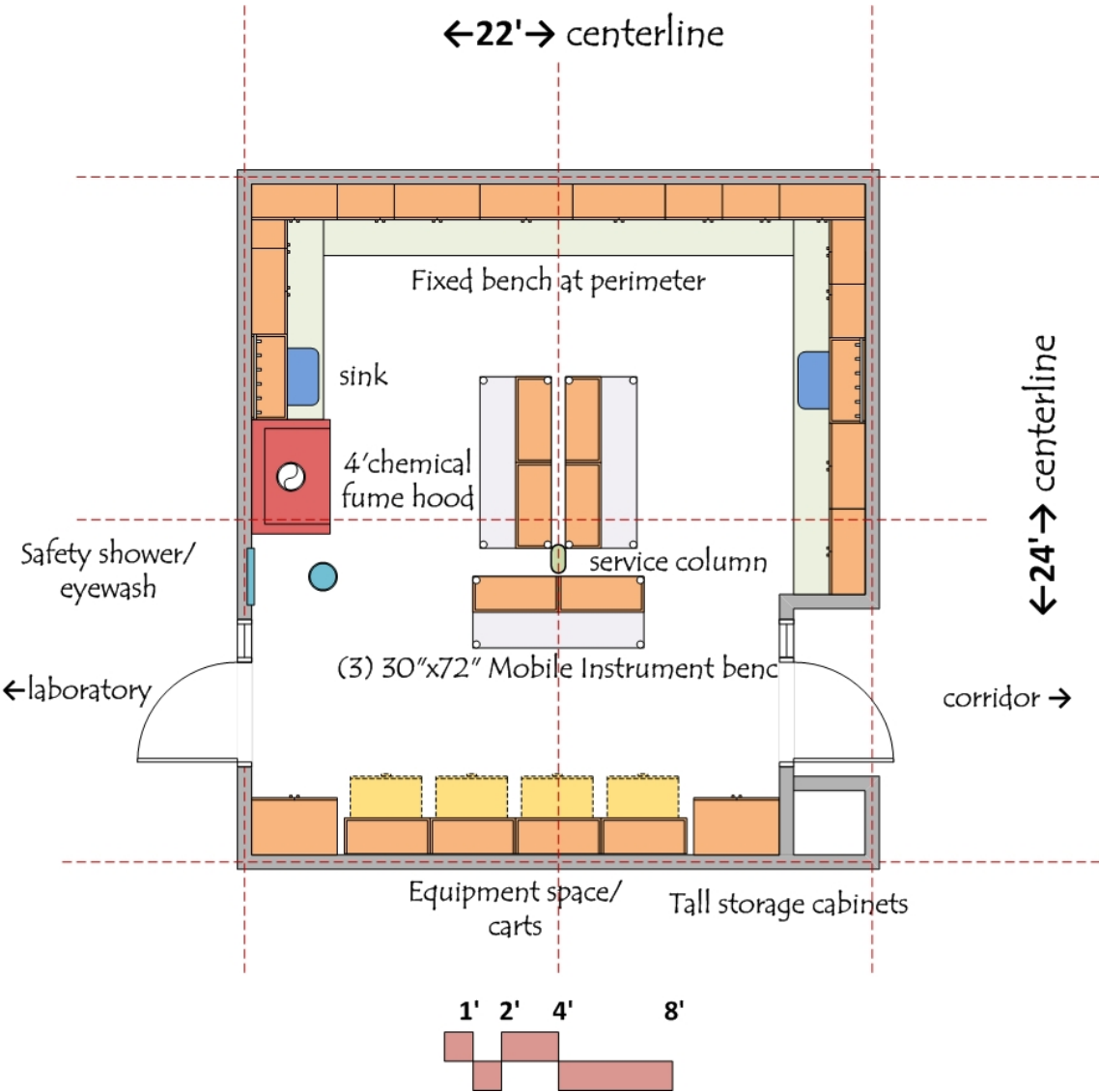

Area Name - Cadaver Room

Space Number - A12

ASF - 427 (face of wall)

Date - June 09, 2014

No. Required - 1

Information received from - Life Science Faculty

General Description - Storage and prep of cadavers
Up to 16 students and instructor for demo purposes

Adjacencies - Direct access to anatomy lab
Near life science prep/stock rooms

Architecture - Occupancy: B
Planning dimensions: 20'x23' (centerline of wall)
Floor: sealed concrete
Walls: gypsum board with epoxy paint
Ceiling: mylar acoustic tile at 9' minimum
Doors: 36x80 with window at corridor
Natural daylight: not required
Acoustic attenuation: NC 40 or less
Security: Card key or punch key access

Mechanical - Temperature: 68 deg F +/- 2 deg F
Humidity: 30-50% relative (dehumidify)
Exhaust: 100% (VAV)
Air change rate: 10/hour 24/7/365
Equipment heat gain: 25 btuh/sf
Low exhaust at perimeter in addition to exhaust at ceiling

Structural - Vibration attenuation: 4,000 microinches per second or less as defined by AISC #11

Plumbing - Hot/Cold water at sinks
Floor drain

Electrical - 115v outlets at all benches
Fourplex at 4' on center at perimeter
Wired and wireless data
Lighting: direct/indirect at 500 Lux

**Contractor
Furnished
Equipment** - Stainless steel casework
Stainless steel tops and sinks
Faucets and fittings (satin chrome)

**College
Furnished
Equipment** - Cadaver gurney tables

Illustration - Cadaver Room
Life Science

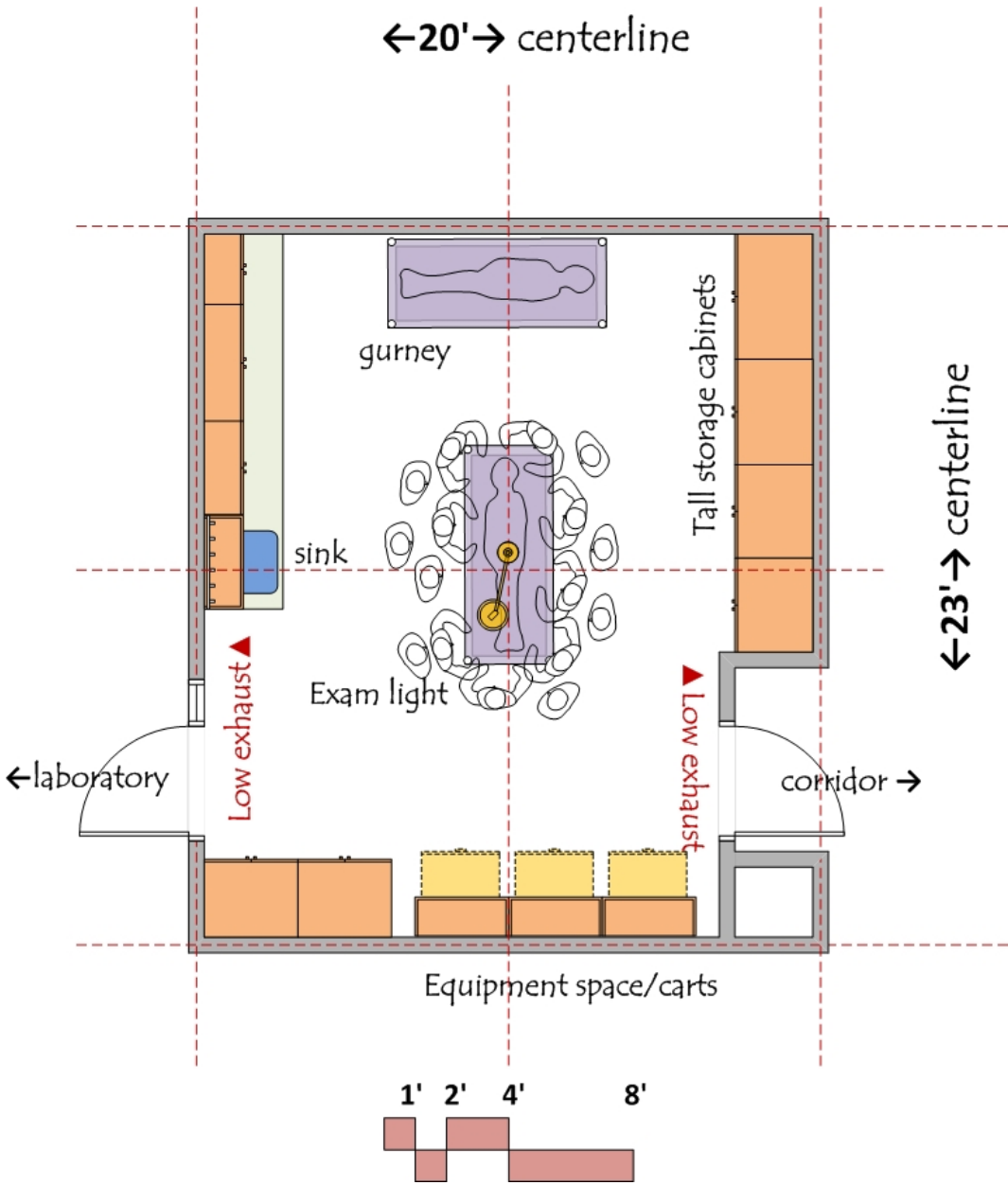

Area Name - Live Animal Room

Space Number - A13

ASF - 154 (face of wall)

Date - June 09, 2014

No. Required - 1

Information received from - Life Science Faculty

General Description - Housing for live animals

Adjacencies - Direct access to life science prep
Near life science teaching labs

Architecture - Occupancy: B
Planning dimensions: 13'x14' (centerline of wall)
Floor: sealed concrete
Walls: concrete board with fiberglass and epoxy paint
Ceiling: 9' waterproof gypsum board with epoxy paint
Doors: 36x80 with red window at corridor
Natural daylight: not required
Acoustic attenuation: NC 40 or less
Security: Card key or punch key access

Mechanical - Temperature: 72 deg F +/- 2 deg F
Humidity: 30-50% relative (dehumidify)
Exhaust: 100% (VAV)
Air change rate: 10/hour 24/7/365

Structural - Vibration attenuation: 4,000 microinches per second or less as defined by AISC #11

Plumbing - Hot/Cold water at sink
Cold water at hose bib at wall
Floor drain with sediment trap

Electrical - 115v outlets at all benches
Fourplex at 4' on center at perimeter
Wired and wireless data
Lighting: gasket sealed direct at 500 Lux
Circadian lighting controls

**Contractor
Furnished
Equipment** - Stainless steel sink
Faucet: satin chrome
Stainless steel tall storage cabinet

**College
Furnished
Equipment** - Animal cages
Refrigerator

Illustration - Live Animal Room
Life Science

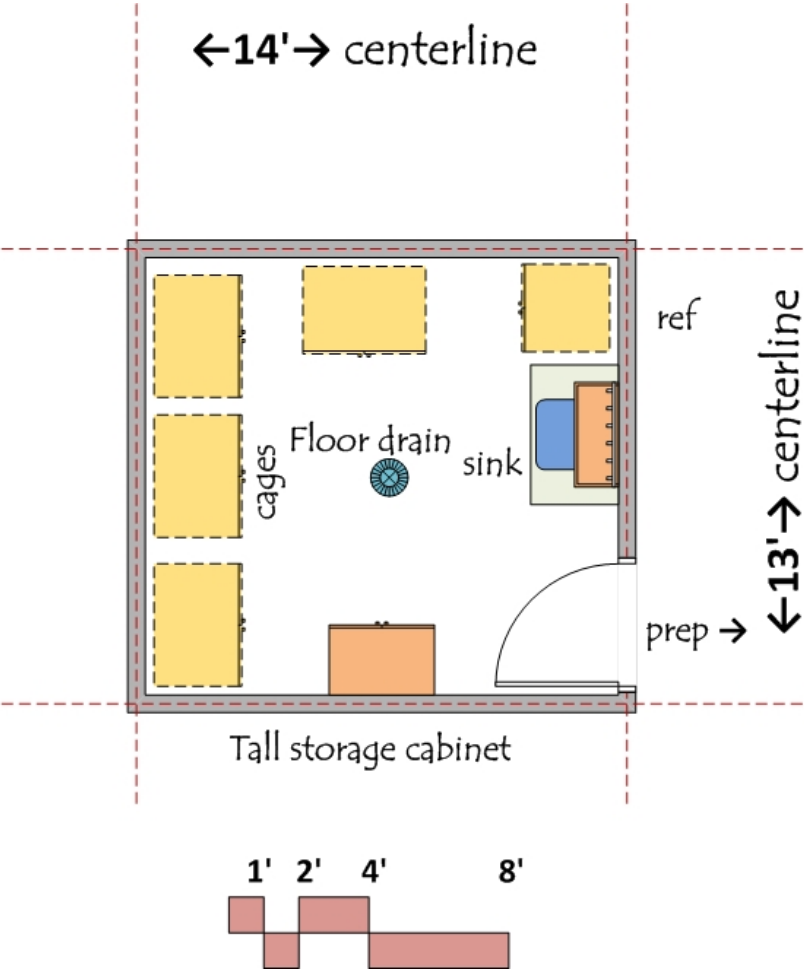

Area Name - Dead Animal Room

Space Number - A14

ASF - 154 (face of wall)

Date - June 09, 2014

No. Required - 1

Information received from - Life Science Faculty

General Description - Storage of taxidermy animals

Adjacencies - Direct access to life science prep
Near life science teaching labs

Architecture - Occupancy: B
 Planning dimensions: 13'x14' (centerline of wall)
 Floor: sealed concrete or VCT
 Walls: gypsum board with enamel paint
 Ceiling: 9' gypsum board with enamel paint
 Doors: 36x80 with window at corridor
 Natural daylight: none required
 Acoustic attenuation: NC 40 or less
 Security: Card key or punch key access

Mechanical - Temperature: 72 deg F +/- 2 deg F
 Humidity: 30-50% relative
 Exhaust: 100% (VAV)
 Air change rate: 4/hour occupied; 2/hour unoccupied

Structural - Vibration attenuation: 4,000 microinches per second or less as defined by AISC #11

Plumbing - None required

Electrical - 115v outlets at perimeter wall
 wireless data
 Lighting: direct/indirect at 500 Lux

**Contractor
 Furnished
 Equipment** - Tall storage cabinets

**College
 Furnished
 Equipment** - None

Illustration - Dead Animal Room
Life Science - "Dry"

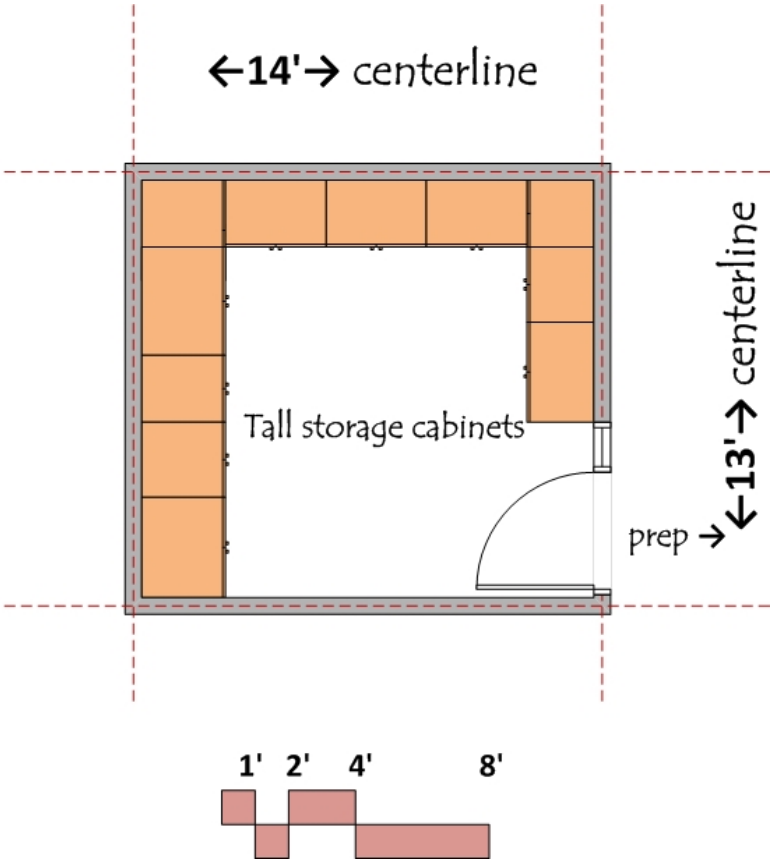

Area Name - Tissue Culture Room

Space Number - A15

ASF - 154 (face of wall)

Date - June 09, 2014

No. Required - 1

Information received from - Life Science Faculty

General Description - Procedure space for tissue culture

Adjacencies - Direct access to Biotech prep
Near life science teaching labs

Architecture - Occupancy: B
Planning dimensions: 13'x14' (centerline of wall)
Floor: sealed concrete or VCT
Walls: gypsum board with enamel paint
Ceiling: mylar acoustic tile at 9' minimum
Doors: 36x80 with window at corridor
Natural daylight: none required
Acoustic attenuation: NC 40 or less
Security: Card key or punch key access

Mechanical - Temperature: 72 deg F +/- 2 deg F
Humidity: ambient
Exhaust: 100% (VAV)
Air change rate: 6/hour occupied;
4 per hour unoccupied
Equipment heat gain: 50 btuh/sf

Structural - Vibration attenuation: 4,000 microinches per second or less as defined by AISC #11

Plumbing - Hot/Cold water at sink
Pure water at sink
Domestic water at safety shower/eyewash
Natural gas, vac at benches
Drain at eyewash
Floor drain at safety shower
Emer gas shut-off
Argon, He, CO2, cylinder gases

Electrical - 115v outlets at all benches
Fourplex at 4' on center at perimeter
Standby power at equipment space
Wired and wireless data
Lighting: direct/indirect at 500 Lux

Contractor Furnished Equipment - Wood casework (bamboo veneer over plywood/MDF substrate)
Epoxy tops and sinks (black epoxy tops)
Faucets and fittings (satin chrome)
Mobile lab table
Biological Safety Cabinet with thimble exhaust
Fire ext. cabinet

College Furnished Equipment - Chairs, stools
Benchtop analytical instruments
Scientific equipment
Refrigerator
Incubators

Illustration - Tissue Culture Room
Life Science

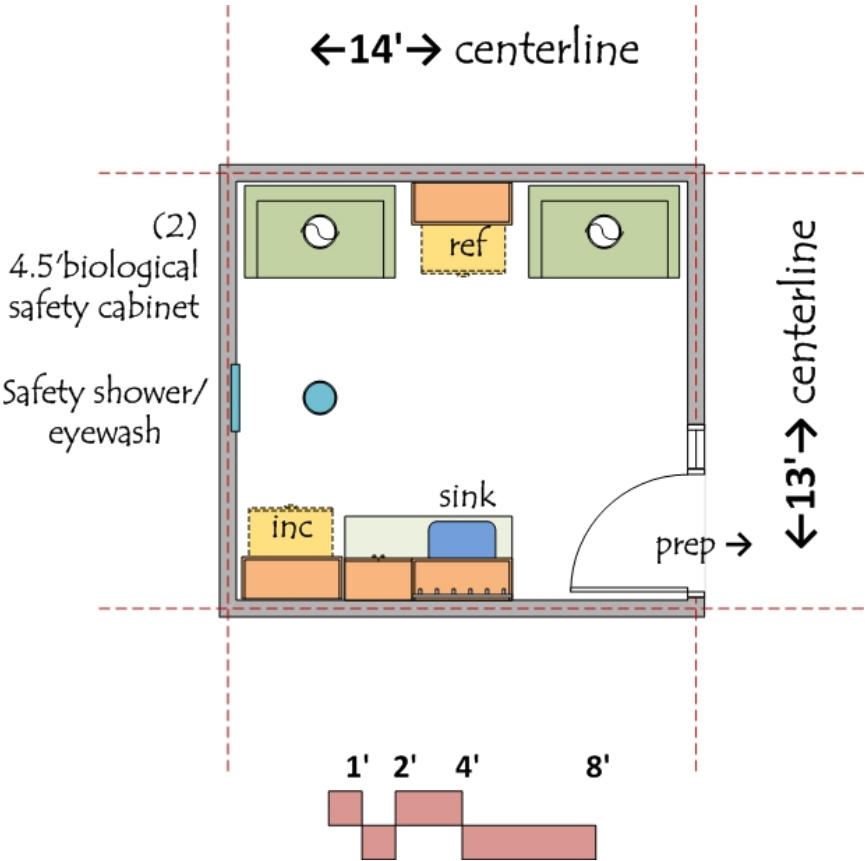

Area Name - Specimen Store Room

Space Number - A16

ASF - 154 (face of wall)

Date - June 09, 2014

No. Required - 1

Information
received from - Life Science FacultyGeneral
Description - Storage of preserved specimensAdjacencies - Direct access to life science prep
Near anatomy teaching labs

Architecture - Occupancy: B
Planning dimensions: 15'x15' (centerline of wall)
Floor: sealed concrete or VCT
Walls: gypsum board with enamel paint
Ceiling: mylar acoustic tile at 9' minimum
Doors: 36x80 with window at corridor
Natural daylight: exterior windows with light attenuation
Acoustic attenuation: NC 40 or less
Security: Card key or punch key access

Mechanical - Temperature: 72 deg F +/- 2 deg F
Humidity: ambient
Exhaust: 100% (VAV)
Air change rate: 6/hour occupied;
4 per hour unoccupied

Structural - Vibration attenuation: 4,000 microinches per second or
less as defined by AISC #11

Plumbing - None

Electrical - 115v outlets
wireless data
Lighting: direct/indirect at 500 Lux

**Contractor
Furnished
Equipment** - Specimen storage cabinets

**College
Furnished
Equipment** - None

Illustration - Specimen Store Room
Life Science - "Wet"

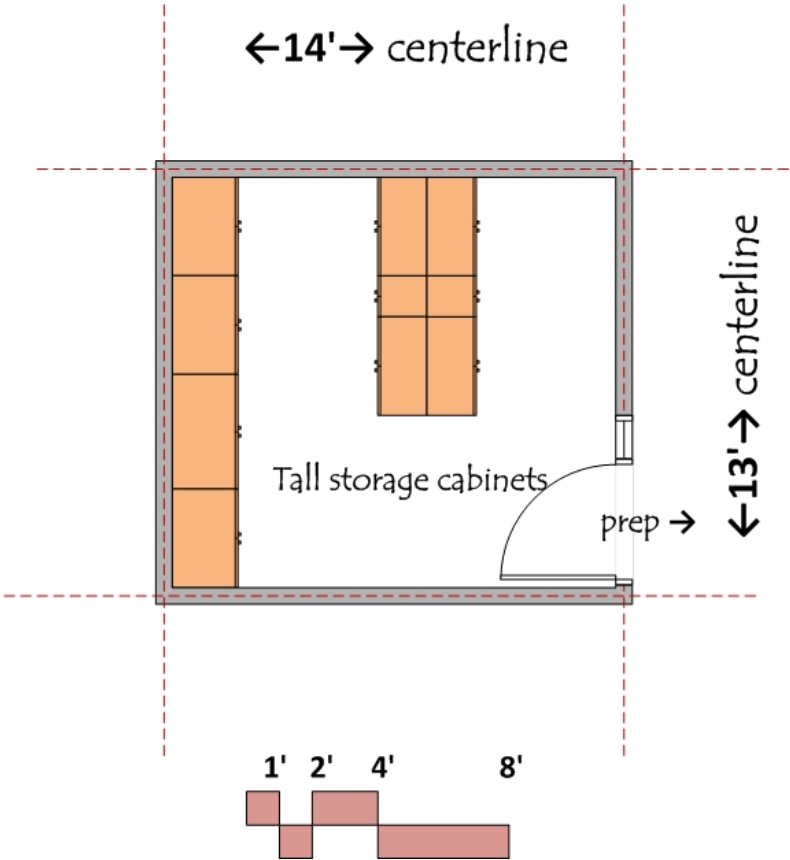

Area Name - Autoclave Room

Space Number - A17

ASF - 154 (face of wall)

Date - June 09, 2014

No. Required - 1

Information received from - Life Science Faculty

General Description - Sterilization of waste and biological samples

Adjacencies - Near life science teaching labs
Near life science prep/stock rooms

Architecture - Occupancy: B
Planning dimensions: 13'x14' (centerline of wall)
Floor: sealed concrete
Walls: waterproof gypsum board with epoxy paint
Ceiling: mylar acoustic tile at 9' minimum
Doors: 36x80 with window at corridor
Natural daylight: none required
Acoustic attenuation: NC 40 or less
Security: Card key or punch key access

Mechanical - Temperature: 72 deg F +/- 2 deg F
Humidity: ambient
Exhaust: 100% (VAV)
Air change rate: 6/hour occupied 24/7/365
Exhaust at corrosive cabinets

Structural - Vibration attenuation: 4,000 microinches per second or less as defined by AISC #11

Plumbing - Hot/Cold water at sink
Pure water at sink
Floor sink

Electrical - 115v outlets at all benches
Fourplex at 4' on center at perimeter
wireless data
Lighting: direct/indirect at 500 Lux

Contractor Furnished Equipment - Stainless steel casework, sink, tops
(2) Autoclaves
Carts

College Furnished Equipment - None

Illustration - Autoclave Room
Life Science

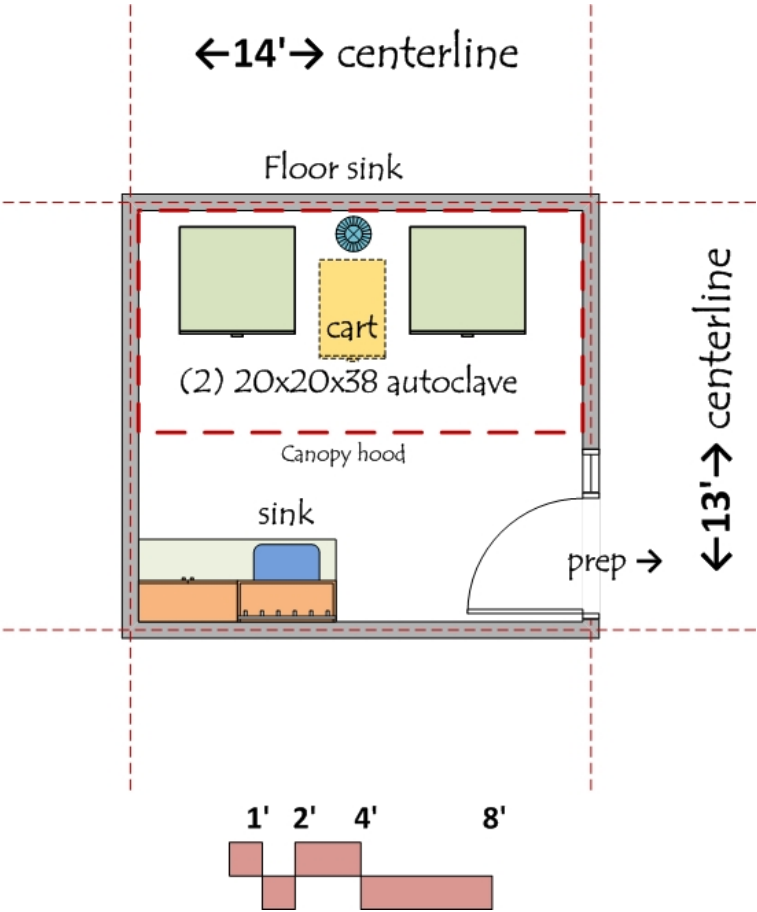

Area Name - Chemical Store Room

Space Number - A18

ASF - 156 (face of wall)

Date - June 09, 2014

No. Required - 1

Information
received from - Life Science FacultyGeneral
Description - Chemical storage for life sciences

Adjacencies - Direct access to life science prep

Architecture - Occupancy: B
 Planning dimensions: 15'x15' (centerline of wall)
 Floor: sealed concrete
 Walls: gypsum board with enamel paint
 Ceiling: acoustic tile at 9' minimum
 Doors: 36x80 with window at corridor
 Natural daylight: exterior windows with light attenuation
 Acoustic attenuation: NC 40 or less
 Security: Card key or punch key access

Mechanical - Temperature: 72 deg F +/- 2 deg F
 Humidity: ambient
 Exhaust: 100% (VAV)
 Air change rate: 6/hour 24/7/365
 50 cfm exhaust at each corrosive cabinet

Structural - Vibration attenuation: 4,000 microinches per second or
 less as defined by AISC #11

Plumbing - Domestic water at safety shower/eyewash
 Drain at eyewash
 Floor drain at safety shower

Electrical - 115v outlets at perimeter
 wireless data
 Lighting: direct/indirect at 500 Lux

**Contractor
Furnished
Equipment** - Tall open shelves for non-corrosives, non-flammables
 Corrosive storage cabinets (vented)
 Flammable storage cabinets (not vented)

**College
Furnished
Equipment** - Chemical storage containers

Illustration - Chemical Store Room
Life Science

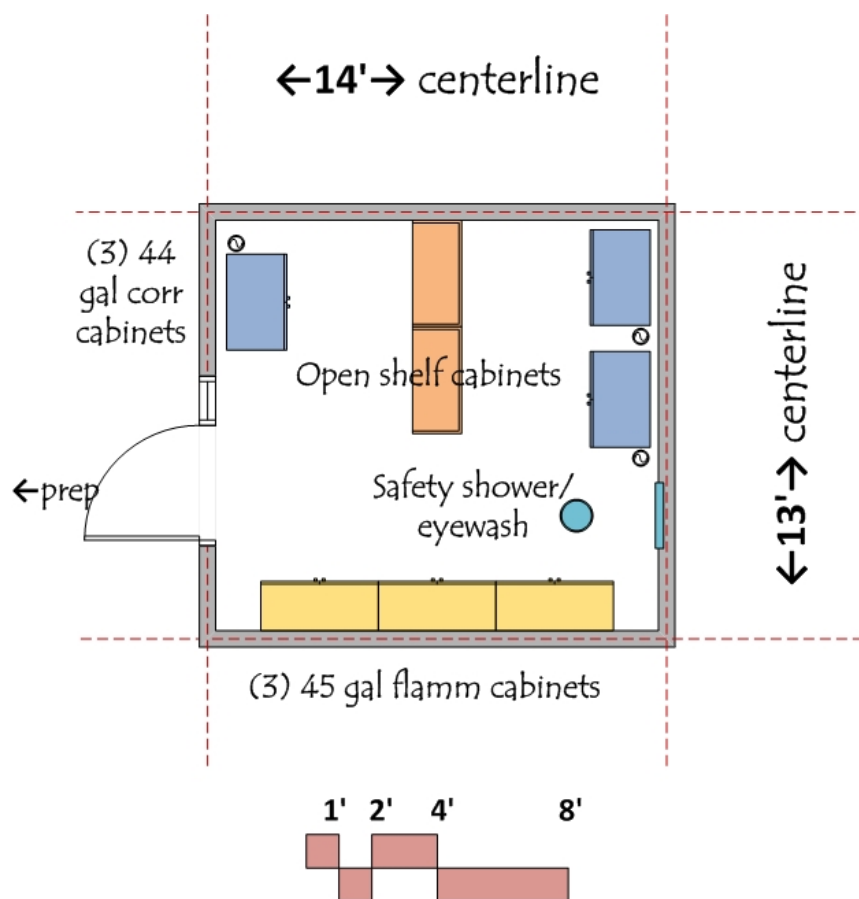

Area Name - Greenhouse

Space Number - A19

ASF - 361 (face of wall)

Date - July 11, 2014

No. Required - 1

Information
received from - Life Science FacultyGeneral
Description - Plant growth environment for life scienceAdjacencies - Near life science teaching labs
Near life science prep/stock rooms
Locate on ground floor

Architecture - Occupancy: B
 Planning dimensions: 20'x20' (centerline of wall)
 Floor: sealed concrete
 Walls: glass panels
 Ceiling: sloped glass panels at 12'
 Doors: 36x80 glass panel
 Natural daylight: with attenuation
 Acoustic attenuation: NC 40 or less
 Security: Card key or punch key access

Mechanical - Temperature: 68-85 deg F
 Humidity: ambient

Structural - Vibration attenuation: 4,000 microinches per second or
 less as defined by AISC #11

Plumbing - Hot/Cold water at sinks
 Floor drains with sediment traps
 Watering system for plants (recycled water)
 Swamp cooler

Electrical - 115v outlets at all benches
 Fourplex at 4' on center at perimeter
 wireless data
 Lighting: direct at 300 Lux

**Contractor
Furnished
Equipment** - Stainless steel plant tables
 Stainless steel casework, sinks, tops

**College
Furnished
Equipment** - None

Illustration - Green House
Life Science

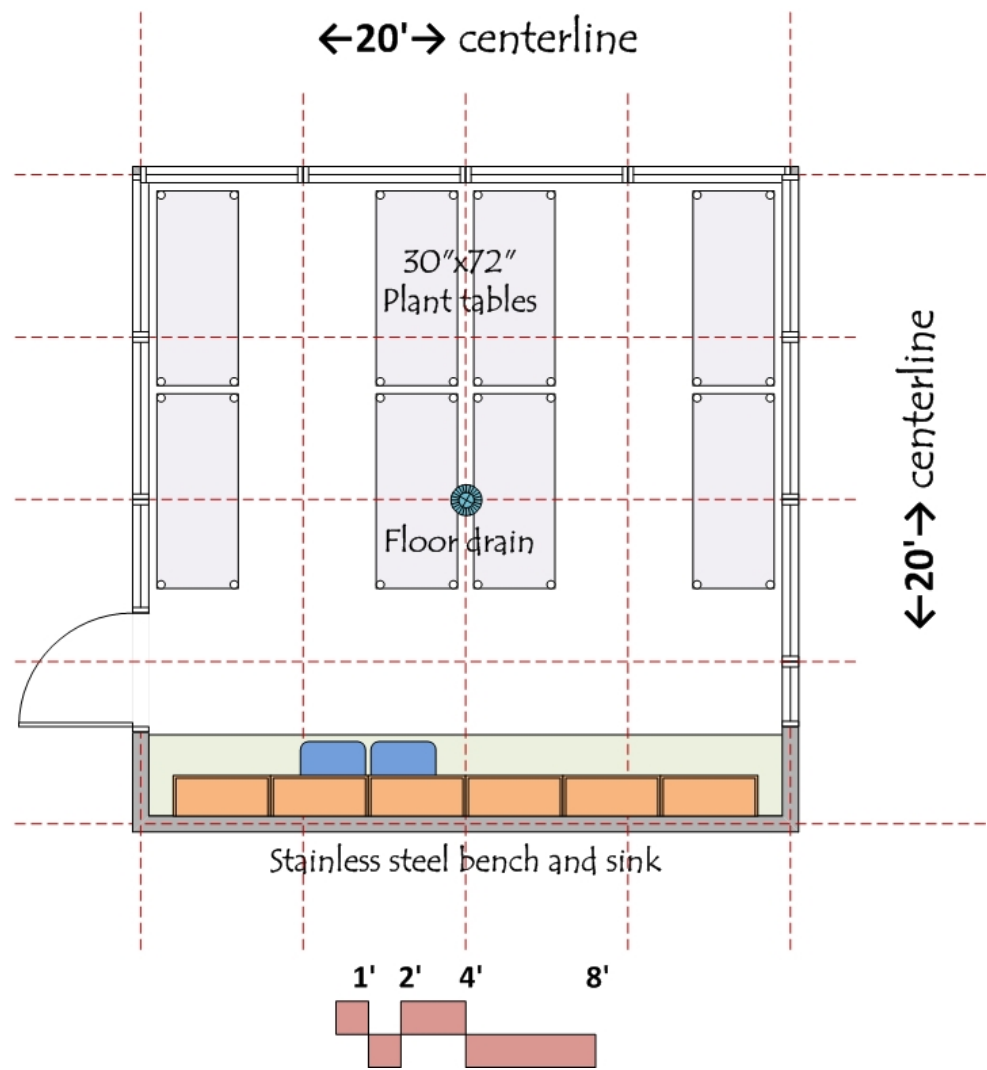

Area Name - Biopond

Space Number - A20

ASF - 361 (face of perimeter enclosure)

Date - June 09, 2014

No. Required - 1

Information
received from - Life Science Faculty

General Description - Project and research activities for live aquatic animals
100-200 s.f. surface area of pond
Minimum 4ft depth for pond

Adjacencies - Near life science teaching labs

Architecture - Occupancy: B
Planning dimensions: 20'x20' (centerline of perimeter enclosure)
Floor: stone pavers
Walls: fenced perimeter
Ceiling: overhead shade structure
Doors: 6' opening

Mechanical - None**Structural** - Concrete pond- 4' depth

Plumbing - Water supply and treatment for pond
Domestic cold water hose bib
Integrated fill valve with reclaimed water
Drain at lowest point of pond for periodic flush and maintenance
Filtration- mechanical pressure filtration, external canister in-line flowthrough
UV sterilizer, minimum 30 watts
Pump capacity: 6500-7500 gallons per hour

Electrical - Waterproof 115v duplex outlet

**Contractor
Furnished
Equipment** - Pond, landscaping
3-4 benches for seating
Shade structure
Perimeter enclosure

**College
Furnished
Equipment** - None

Illustration - Biopond
Life Science

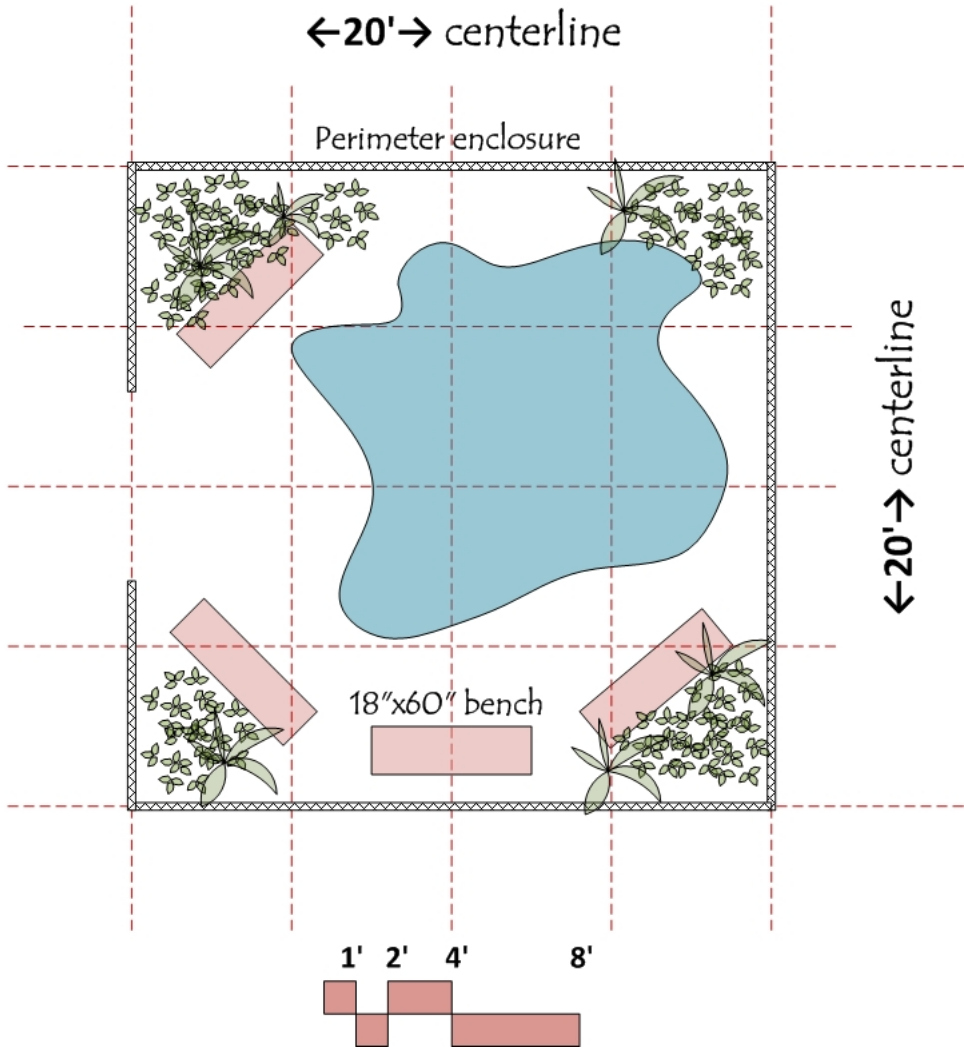

Area Name - Laboratory Type F

Space Number - B1

ASF - 1,617 (face of wall)

Date - July 11, 2014

No. Required - 2

Information received from - Physical Science Faculty

General Description - Physical Science Instructional Laboratory for Astronomy, Physics, Geology & Geography
Number of Students: 32

Adjacencies - Direct access to prep/stock room
Near other physical science labs
Locate on the ground floor

Architecture - Occupancy: B
Planning dimensions: 34'x50' (centerline of wall)
Floor: sealed concrete or VCT
Walls: gypsum board with enamel paint
Ceiling: acoustic tile at 10'
Doors: 36x80 with window at corridor; 36x80 dutch door at prep room
Natural daylight: exterior windows with light attenuation (blackout)
Acoustic attenuation: NC 40 or less
Security: Card key or punch key access

Mechanical - Temperature: 72 deg F +/- 2 deg F
Humidity: ambient
Exhaust: 100% (VAV)
Air change rate: 4/hour occupied;
2 per hour unoccupied
Equipment heat gain: 25 btuh/sf

Structural - Vibration attenuation: 4,000 microinches per second or less as defined by AISC #11

Plumbing - Hot/Cold water at sinks
Pure water at sinks
Compressed air at student stations
Domestic water at safety shower/eyewash
Drain at eyewash
Floor drain at safety shower

Electrical - 115v outlets at all benches
(2) duplex at each student station
Fourplex at 4' on center at perimeter
Standby power at equipment space
Wired and wireless data
Lighting: direct/indirect at 500 Lux with dimmer switch
4" conduit to roof astronomy platform

Contractor Furnished Equipment - Wood casework (bamboo veneer over plywood/MDF substrate)
Epoxy tops and sinks (dark green epoxy tops)
Faucets and fittings (satin chrome)
Mobile lab benches
Marker boards- vertical sliding
Unistrut frame at ceiling
Fire ext. cabinet

College Furnished Equipment - Chairs, stools
Benchtop analytical instruments
Scientific equipment
Projection system
Wall charts

Illustration - Laboratory Type F
Astronomy, Physics, Geology & Geography
(2) Labs

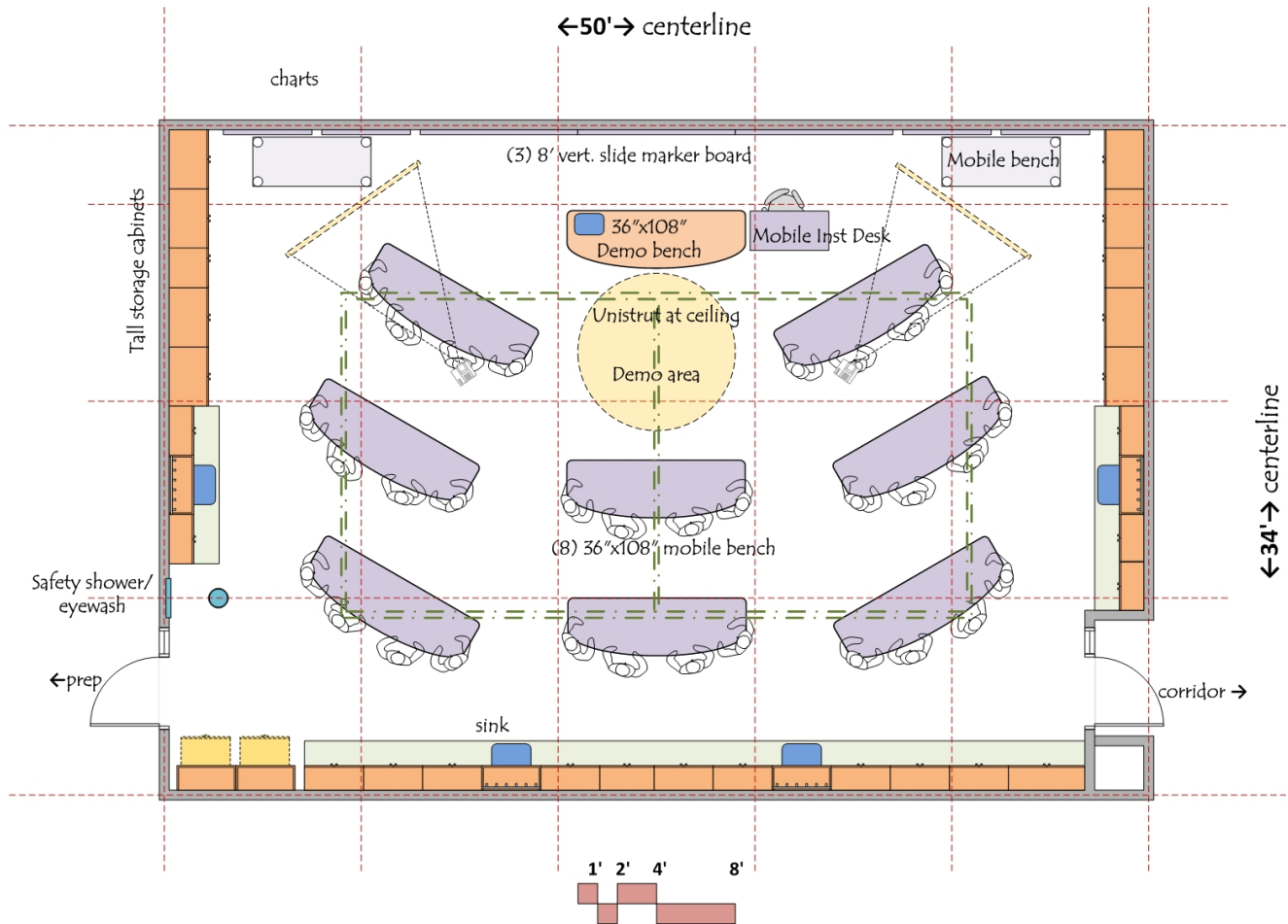

Area Name - Laboratory Type G

Space Number - B2

ASF - 1,617 (face of wall)

Date - July 11, 2014

No. Required - 3 (choose short of long island option)

Information received from - Physical Science Faculty

General Description - Physical Science Instructional Laboratory for General Chemistry
Number of Students: 24

Adjacencies - Direct access to prep/stock room
Direct access to balance room
Near other physical science labs
Locate on top floor

Architecture - Occupancy: B
Planning dimensions: 34'x50' (centerline of wall)
Floor: sealed concrete or VCT
Walls: gypsum board with enamel paint
Ceiling: acoustic tile at 10'
Doors: 36x80 with window at corridor; 36x80 dutch door at prep room
Natural daylight: exterior windows with light attenuation
Acoustic attenuation: NC 40 or less
Security: Card key or punch key access

Mechanical - Temperature: 72 deg F +/- 2 deg F
Humidity: ambient
Exhaust: 100% (VAV)
Air change rate: 6/hour occupied;
4 per hour unoccupied
Equipment heat gain: 25 btuh/sf
8' Chemical Fume Hood: 1,050 c.f.m. (VAV)
4' Chemical Fume Hood: 450 c.f.m. (VAV)

Structural - Vibration attenuation: 4,000 microinches per second or less as defined by AISC #11

Plumbing - Hot/Cold water at sinks
Pure water at sinks
Domestic water at safety shower/eyewash
Natural gas, vac, air at each student station
Natural gas, vac, air at each fume hood
Drain at eyewash
Floor drain at safety shower
Emer gas shut-off

Electrical - 115v outlets at all benches
(1) duplex at each student station
Fourplex at 4' on center at perimeter
Standby power at equipment space
Wired and wireless data
Lighting: direct/indirect at 500 Lux with dimmer switch

Contractor Furnished Equipment - Contractor Furnished Equipment
Wood casework (bamboo veneer over plywood/MDF substrate)
Epoxy tops and sinks (dark green epoxy tops)
Faucets and fittings (satin chrome)
Chemical fume hoods
Mobile lab benches
Marker boards- vertical sliding
Fire ext. cabinet

College Furnished Equipment - Chairs, stools
Benchtop analytical instruments
Scientific equipment
Projection system
Wall charts

Illustration - Laboratory Type G
General Chemistry
(3) Labs

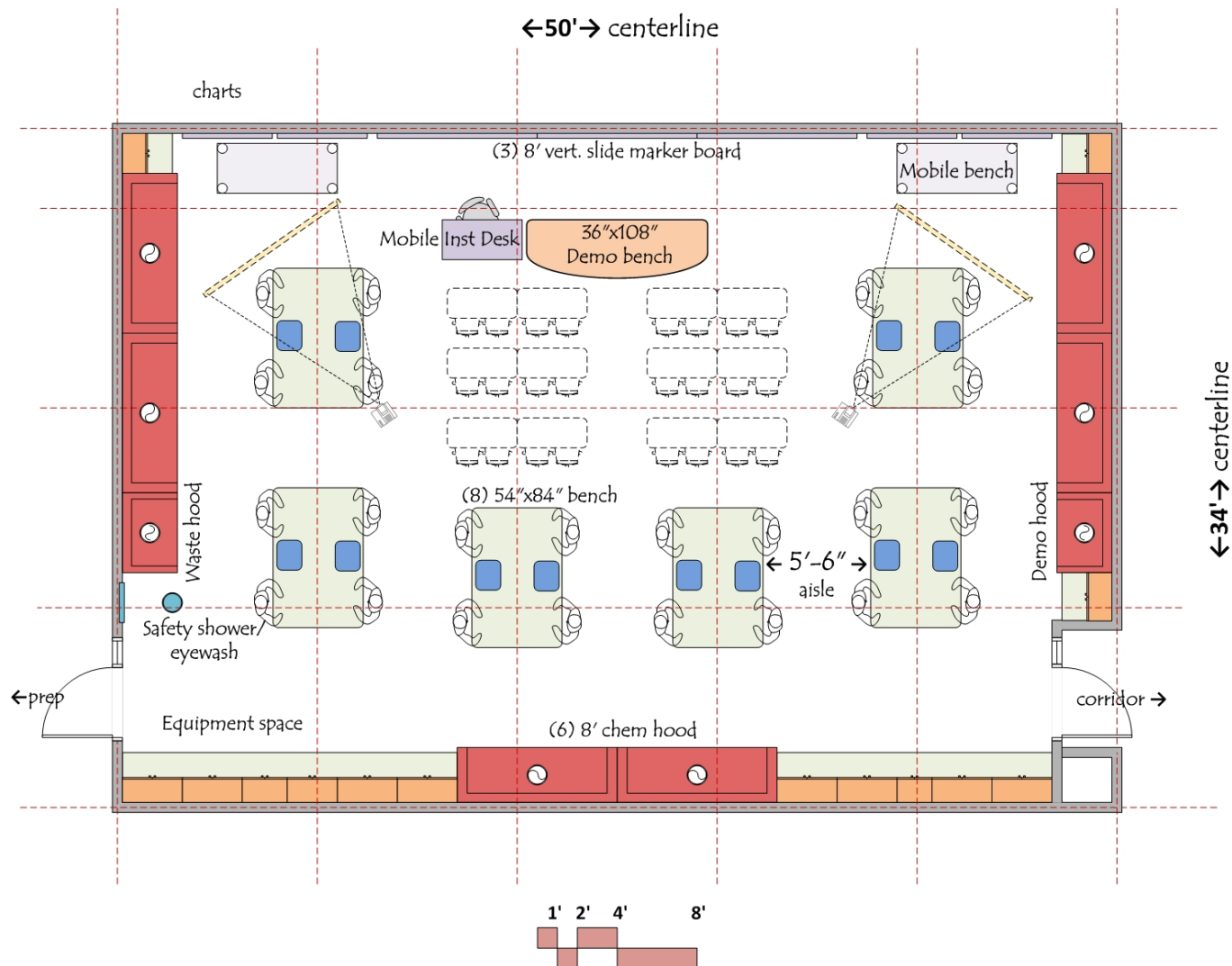
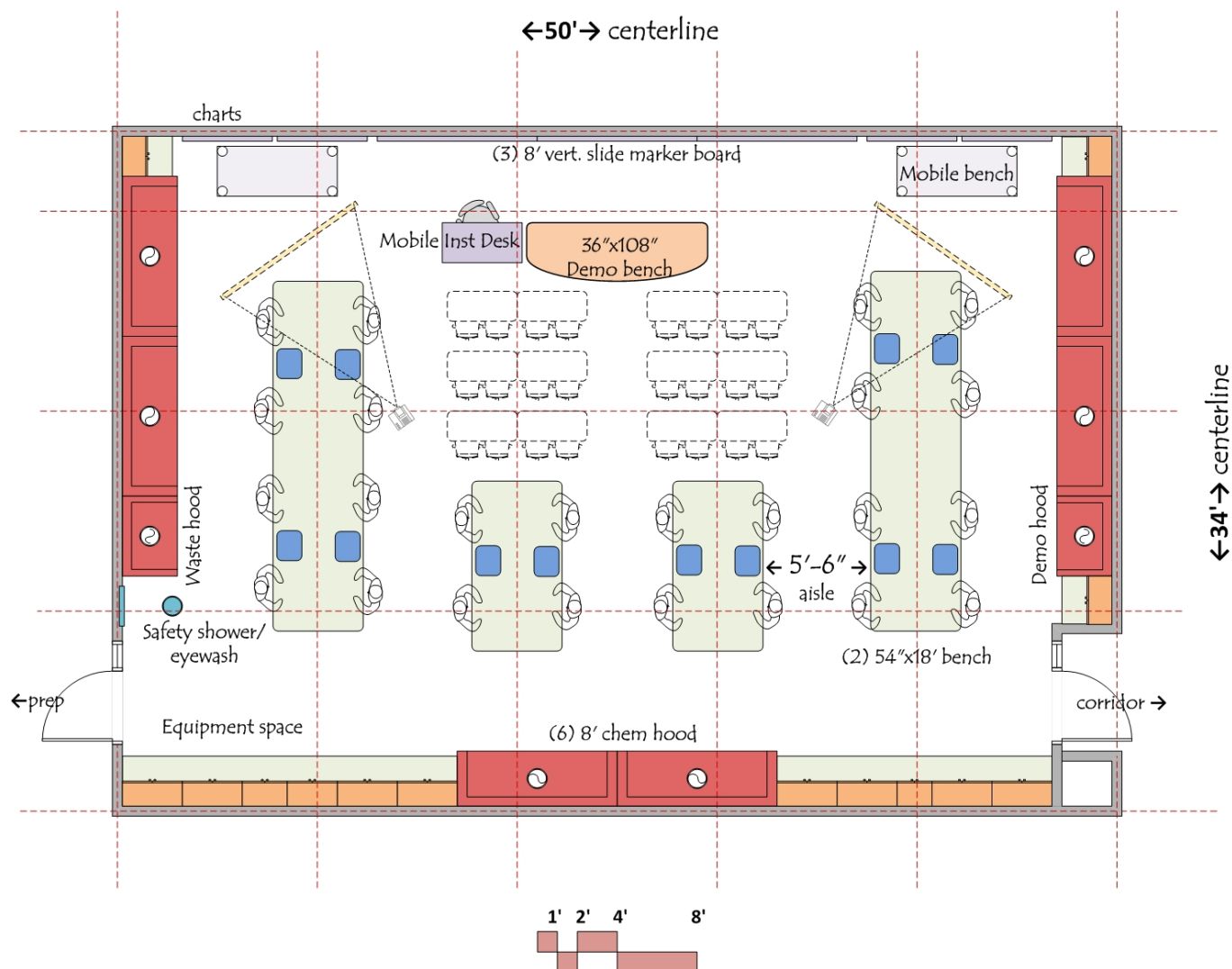

Illustration - Laboratory Type G
General Chemistry - Option for lower level chem (100 series)



Area Name - Laboratory Type H

Space Number - B3

ASF - 1,617 (face of wall)

Date - July 11, 2014

No. Required - 1

Information received from - Physical Science Faculty

General Description - Physical Science Instructional Laboratory for Organic Chemistry
Number of Students: 24

Adjacencies - Direct access to prep/stock room
Direct access to instrument/NMR room
Near other physical science labs
Locate on top floor

Architecture - Occupancy: B
Planning dimensions: 34'x50' (centerline of wall)
Floor: sealed concrete or VCT
Walls: gypsum board with enamel paint
Ceiling: acoustic tile at 10'
Doors: 36x80 with window at corridor; 36x80 dutch door at prep room
Natural daylight: exterior windows with light attenuation
Acoustic attenuation: NC 40 or less
Security: Card key or punch key access

Mechanical - Temperature: 72 deg F +/- 2 deg F
Humidity: ambient
Exhaust: 100% (VAV)
Air change rate: 6/hour occupied;
4 per hour unoccupied
Equipment heat gain: 25 btuh/sf
6' Chemical Fume Hood: 750 c.f.m. (VAV)
4' Chemical Fume Hood: 450 c.f.m. (VAV)

Structural - Vibration attenuation: 4,000 microinches per second or less as defined by AISC #11

Plumbing - Hot/Cold water at sinks
Pure water at sinks
Domestic water at safety shower/eyewash
Natural gas, vac, air at each student station
Natural gas, vac, air at each fume hood
Nitrogen gas at each fume hood and student station
Drain at eyewash
Floor drain at safety shower
Emer gas shut-off

Electrical - 115v outlets at all benches
(1) duplex at each student station
Fourplex at 4' on center at perimeter
Standby power at equipment space
Wired and wireless data
Lighting: direct/indirect at 500 Lux with dimmer switch

Contractor Furnished Equipment - Wood casework (bamboo veneer over plywood/MDF substrate)
Epoxy tops and sinks (dark green epoxy tops)
Faucets and fittings (satin chrome)
Chemical fume hoods
Mobile lab tables
Marker boards- vertical sliding
Fire ext. cabinet

College Furnished Equipment - Chairs, stools
Benchtop analytical instruments
Scientific equipment
Projection system
Wall charts

Illustration - Laboratory Type H
Organic Chemistry
(1) Lab

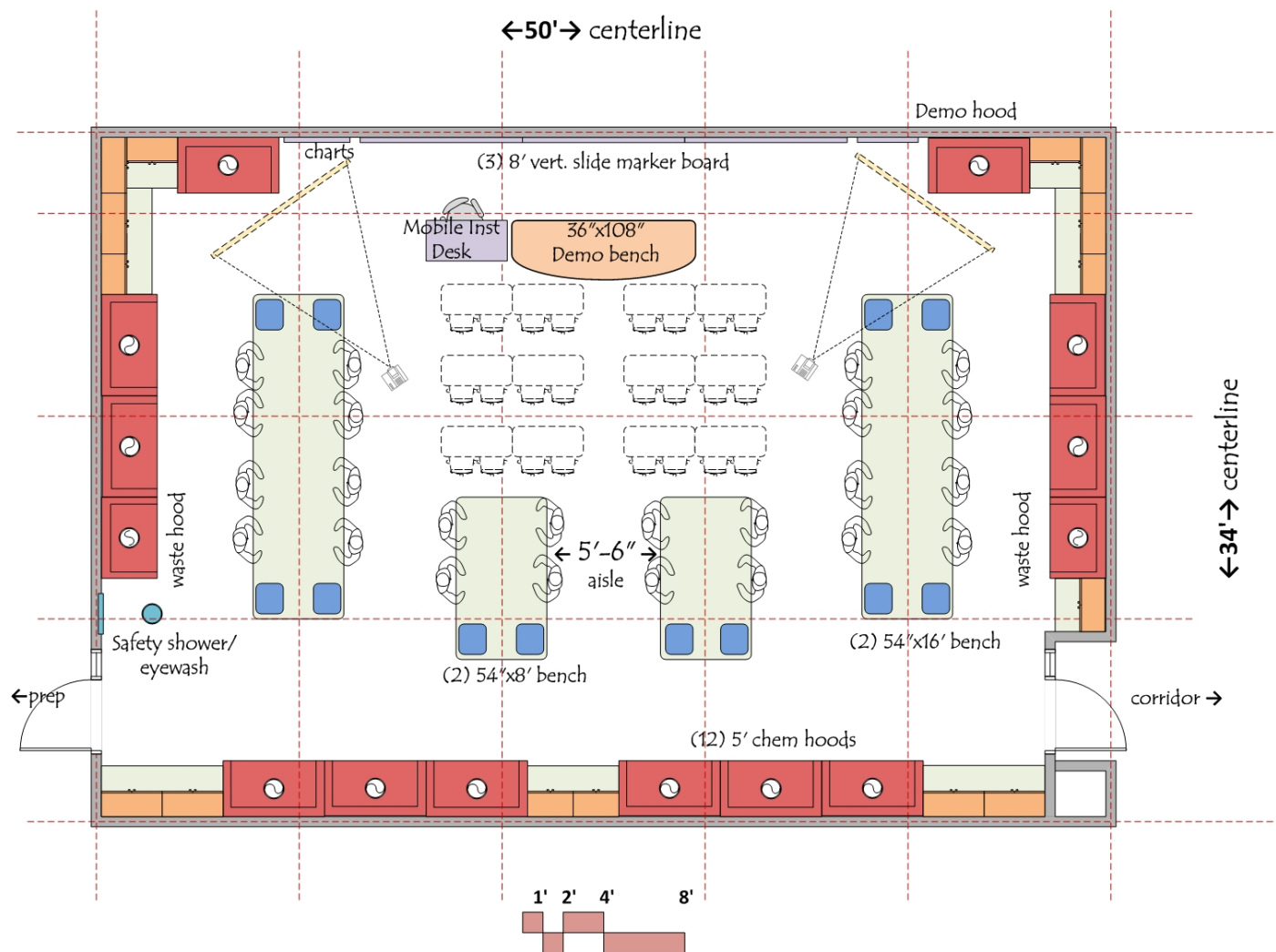

Area Name - Chemistry Prep/Stock

Space Number - B4

ASF - 1,081 (face of wall)

Date - July 11, 2014

No. Required - 1

Information received from - Physical Science Faculty

General Description - Provides prep space and storage space for chemistry teaching labs

Adjacencies - Direct access to chemistry labs
Direct access to instrument/NMR room
Near lecture classrooms
Locate on top floor

Architecture - Occupancy: B
Planning dimensions: 48'x24' (centerline of wall)
Floor: sealed concrete or VCT
Walls: gypsum board with enamel paint
Ceiling: acoustic tile at 9' minimum
Doors: 36x80 with window at corridor; 36x80 dutch door at prep room
Natural daylight: exterior windows with light attenuation
Acoustic attenuation: NC 40 or less
Security: Card key or punch key access

Mechanical - Temperature: 72 deg F +/- 2 deg F
Humidity: ambient
Exhaust: 100% (VAV)
Air change rate: 6/hour occupied;
4 per hour unoccupied
Equipment heat gain: 50 btuh/sf
5' Chemical Fume Hood: 600 c.f.m. (VAV)

Structural - Vibration attenuation: 4,000 microinches per second or less as defined by AISC #11

Plumbing - Hot/Cold water at sinks
Pure water at sinks
Domestic water at safety shower/eyewash
Natural gas, vac, air at benches
Natural gas, vac, air at each fume hood
Nitrogen gas at fume hoods
Drain at eyewash
Floor drain at safety shower
Emer gas shut-off
Argon, CO2, O2 cylinder gases

Electrical - 115v outlets at all benches
Fourplex at 4' on center at perimeter
Standby power at equipment space
Wired and wireless data
Lighting: direct/indirect at 500 Lux

Contractor Furnished Equipment - Wood casework (bamboo veneer over plywood/MDF substrate)
Epoxy tops and sinks (black epoxy tops)
Faucets and fittings (satin chrome)
Chemical fume hoods
Mobile lab tables
Fire ext. cabinet

College Furnished Equipment - Chairs, stools
Benchtop analytical instruments
Scientific equipment

Illustration - Chemistry Prep/Stock

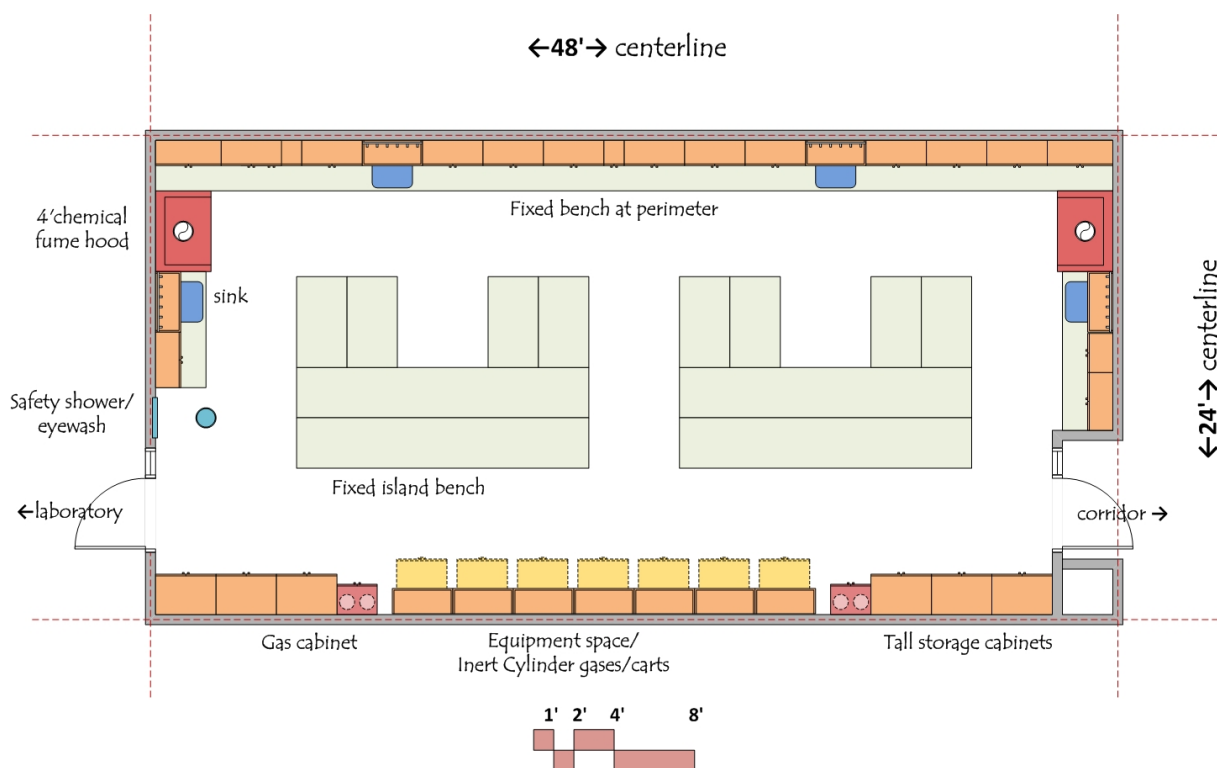

Area Name - Physics & Astronomy Prep/Stock

Space Number - B5

ASF - 741 (face of wall)

Date - July 11, 2014

No. Required - 1

Information received from - Physical Science Faculty

General Description - Provides prep space and storage space for physics/astronomy teaching labs

Adjacencies - Direct access to physics/astronomy labs
Near lecture classrooms
Locate on ground floor

Architecture - Occupancy: B
Planning dimensions: 40'x20' (centerline of wall)
Floor: sealed concrete or VCT
Walls: gypsum board with enamel paint
Ceiling: acoustic tile at 9' minimum
Doors: 36x80 with window at corridor; 36x80 dutch door at prep room
Natural daylight: exterior windows with light attenuation
Acoustic attenuation: NC 40 or less
Security: Card key or punch key access

Mechanical - Temperature: 72 deg F +/- 2 deg F
Humidity: ambient
Exhaust: 100% (VAV)
Air change rate: 4/hour occupied;
2 per hour unoccupied
Equipment heat gain: 25 btuh/sf

Structural - Vibration attenuation: 4,000 microinches per second or less as defined by AISC #11

Plumbing - Hot/Cold water at sinks
Pure water at sinks
Compressed air at lab benches
Domestic water at safety shower/eyewash
Drain at eyewash
Floor drain at safety shower

Electrical - 115v outlets at all benches
Fourplex at 4' on center at perimeter
Standby power at equipment space
Wired and wireless data
Lighting: direct/indirect at 500 Lux

Contractor Furnished Equipment - Wood casework (bamboo veneer over plywood/MDF substrate)
Epoxy tops and sinks (black epoxy tops)
Faucets and fittings (satin chrome)
Mobile lab tables
Fire ext. cabinet

College Furnished Equipment - Chairs, stools
Benchtop analytical instruments
Scientific equipment

Illustration - Physics & Astronomy Prep/Stock

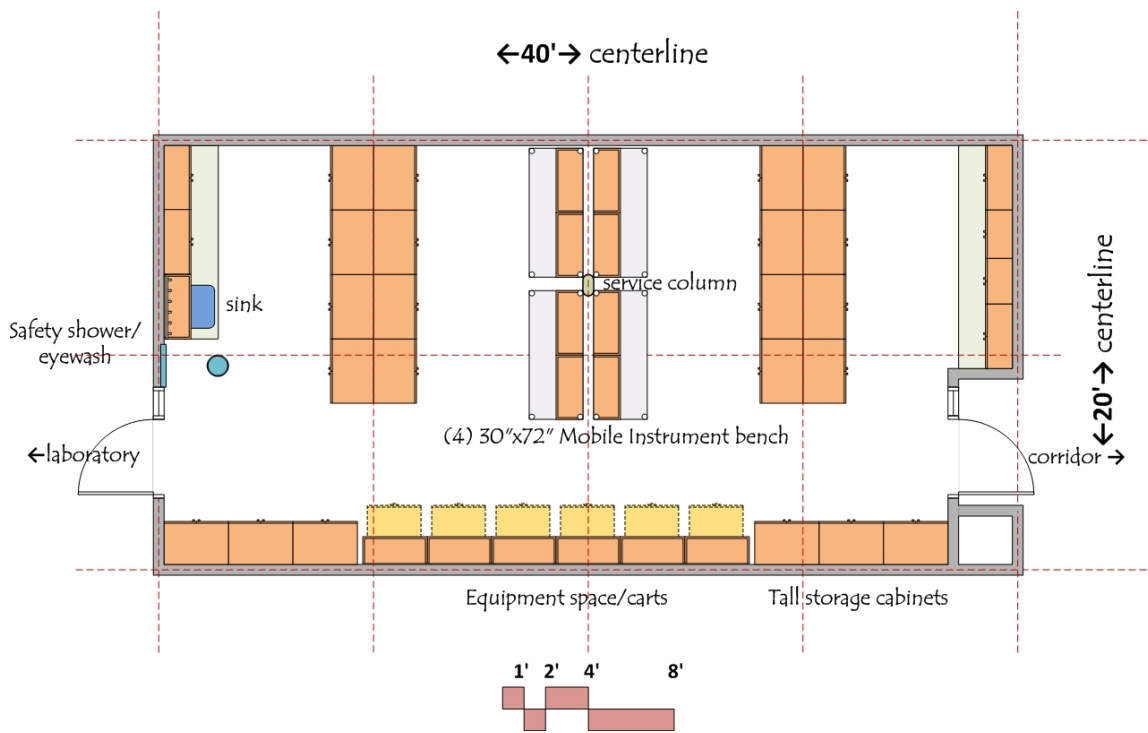

Area Name - Geology & Geography Prep/Stock

Space Number - B6

ASF - 261 (face of wall)

Date - July 11, 2014

No. Required - 1

Information received from - Physical Science Faculty

General Description - Provides prep space and storage space for geology & geography teaching labs

Adjacencies - Direct access to geology/geography labs
Near lecture classrooms
Locate on ground floor

Architecture - Occupancy: B
Planning dimensions: 15'x20' (centerline of wall)
Floor: sealed concrete or VCT
Walls: gypsum board with enamel paint
Ceiling: acoustic tile at 9' minimum
Doors: 36x80 with window at corridor; 36x80 dutch door at prep room
Natural daylight: exterior windows with light attenuation
Acoustic attenuation: NC 40 or less
Security: Card key or punch key access

Mechanical - Humidity: ambient
Exhaust: 100% (VAV)
Air change rate: 4/hour occupied;
2 per hour unoccupied
Equipment heat gain: 25 btuh/sf

Structural - Vibration attenuation: 4,000 microinches per second or less as defined by AISC #11

Plumbing - Hot/Cold water at sinks
Pure water at sinks
Domestic water at safety shower/eyewash
Drain at eyewash
Floor drain at safety shower

Electrical - 115v outlets at all benches
Fourplex at 4' on center at perimeter
Standby power at equipment space
Wired and wireless data
Lighting: direct/indirect at 500 Lux

Contractor Furnished Equipment - Wood casework (bamboo veneer over plywood/MDF substrate)
Epoxy tops and sinks (black epoxy tops)
Faucets and fittings (satin chrome)
Mobile lab tables
Fire ext. cabinet

College Furnished Equipment - Chairs, stools
Benchtop analytical instruments
Scientific equipment

Illustration - Geology & Geography Prep/Stock

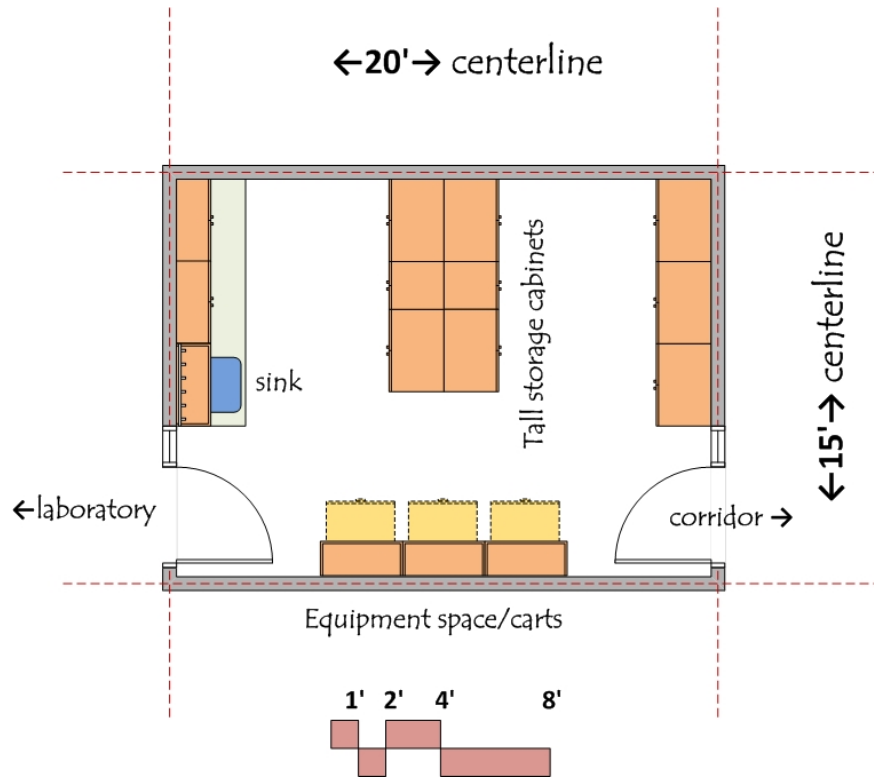

Area Name - Prep/Stock Offices

Space Number - B7

ASF - 150 (face of wall)

Date - July 11, 2014

No. Required - 2

Information received from - Physical Science Faculty

General Description - Provides office work space for lab technicians

Adjacencies - Direct access to physical science prep/stock rooms
Locate within prep/stock
Locate on ground floor

Architecture - Occupancy: B
Planning dimensions: 12'x14' (centerline of wall)
Floor: VCT
Walls: gypsum board with enamel paint
Ceiling: acoustic tile at 9' minimum
Doors: 30x80 with window at corridor;
Natural daylight: exterior windows with light attenuation
Acoustic attenuation: NC 40 or less
Security: Card key or punch key access

Mechanical - Temperature: 72 deg F +/- 2 deg F
Humidity: ambient
Exhaust: 100% (VAV)
Air change rate: 4/hour occupied;
2 per hour unoccupied
Equipment heat gain: 25 btuh/sf

Structural - Vibration attenuation: 4,000 microinches per second or less as defined by AISC #11

Plumbing - None

Electrical - 115v outlets at all benches
Fourplex at 4' on center at perimeter
Wired and wireless data
Lighting: direct/indirect at 400 Lux

Contractor Furnished Equipment - Wood casework to match labs

College Furnished Equipment - Chairs, stools
Computer

Illustration - Prep/Stock Office
Locate within Prep/Stock Rooms

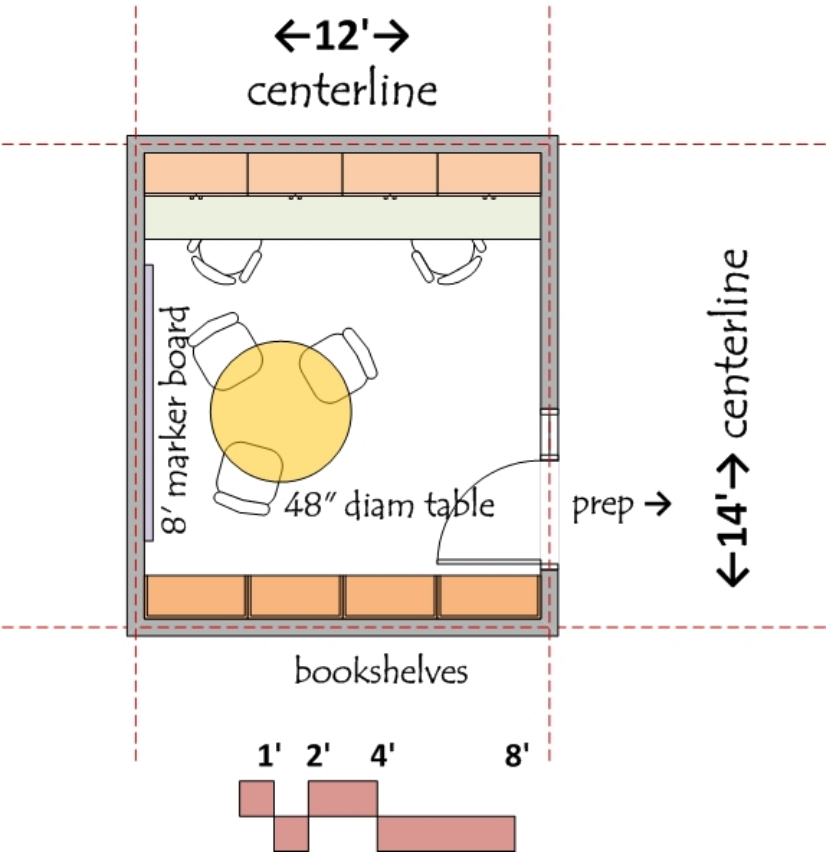

Area Name - Advanced Studies Laboratory

Space Number - B8

ASF - 483 (face of wall)

Date - July 11, 2014

No. Required - 1

Information received from - Physical Science Faculty

General Description - Provides research and project work space for physical science students and faculty

Adjacencies - Near physical science teaching labs
Near physical science prep/stock rooms
Locate on ground floor

Architecture - Occupancy: B
Planning dimensions: 22'x24' (centerline of wall)
Floor: sealed concrete or VCT
Walls: gypsum board with enamel paint
Ceiling: acoustic tile at 10' minimum
Doors: 36x80 with window at corridor
Natural daylight: exterior windows with light attenuation
Acoustic attenuation: NC 40 or less
Security: Card key or punch key access

Mechanical - Temperature: 72 deg F +/- 2 deg F
Humidity: ambient
Exhaust: 100% (VAV)
Air change rate: 6/hour occupied;
4 per hour unoccupied
Equipment heat gain: 50 btuh/sf
5' Chemical Fume Hood: 600 c.f.m. (VAV)

Structural - Vibration attenuation: 4,000 microinches per second or less as defined by AISC #11

Plumbing - Hot/Cold water at sinks
Pure water at sinks
Domestic water at safety shower/eyewash
Natural gas, vac, air at benches
Natural gas, vac, air at each fume hood
Drain at eyewash
Floor drain at safety shower
Emer gas shut-off
Argon, He, CO2, O2 cylinder gases

Electrical - 115v outlets at all benches
Fourplex at 4' on center at perimeter
Standby power at equipment space
Wired and wireless data
Lighting: direct/indirect at 500 Lux

Contractor Furnished Equipment - Wood casework (bamboo veneer over plywood/MDF substrate)
Epoxy tops and sinks (black epoxy tops)
Faucets and fittings (satin chrome)
(2) Chemical fume hoods- VAV
Mobile lab instrument tables
Fire ext. cabinet

College Furnished Equipment - Chairs, stools
Benchtop analytical instruments
Scientific equipment

Illustration - Advanced Studies Laboratory
Physical Science

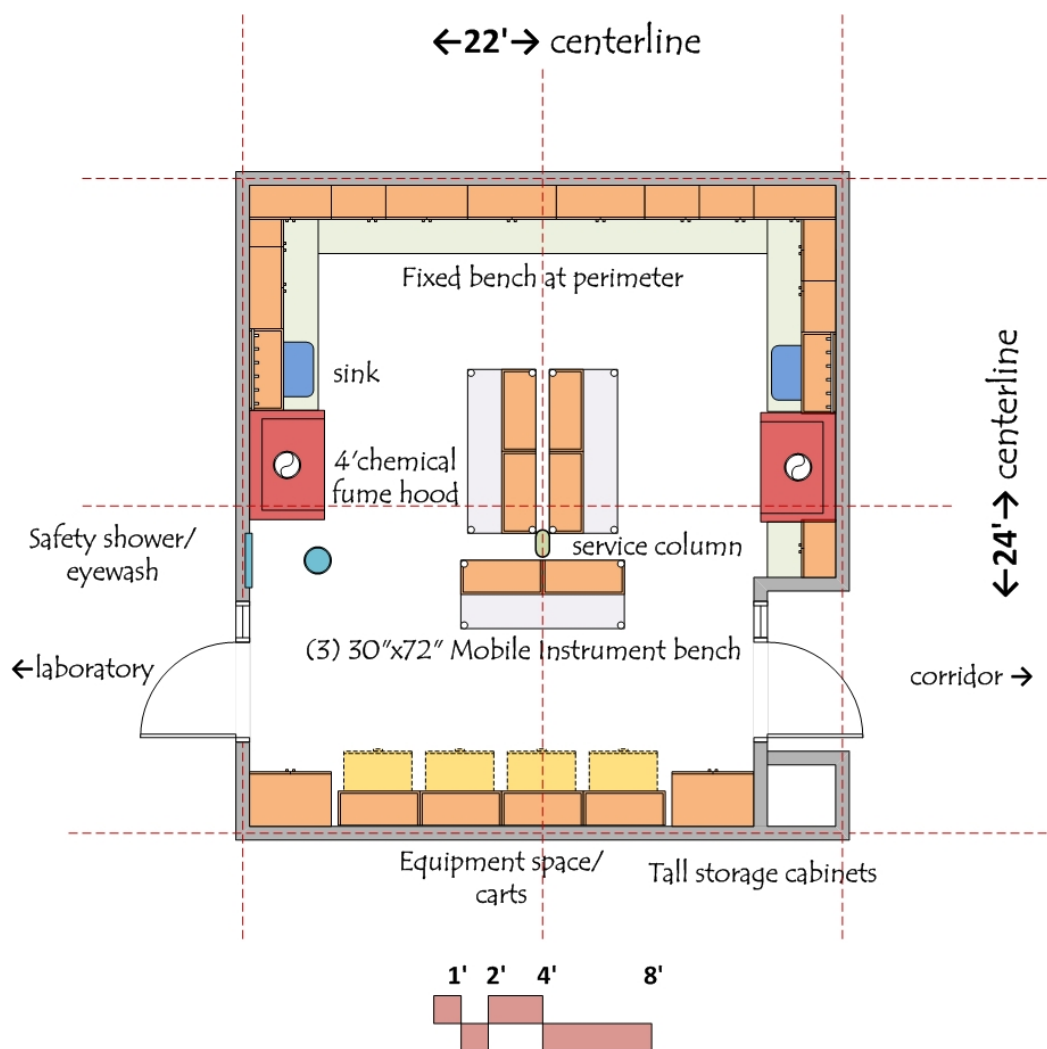

Area Name - Instrument Room

Space Number - B9

ASF - 897 (face of wall)

Date - July 11, 2014

No. Required - 1

Information received from - Physical Science Faculty

General Description - Instruments for organic chemistry lab

Adjacencies - Direct access to organic chemistry lab and one general chemistry lab
Direct access or near prep room
Locate on top floor

Architecture - Occupancy: B
Planning dimensions: 40'x24' (centerline of wall)
Floor: sealed concrete or VCT
Walls: gypsum board with enamel paint
Ceiling: acoustic tile at 9' minimum
Doors: 36x80 with window
Natural daylight: not required
Acoustic attenuation: NC 40 or less
Security: Card key or punch key access

Mechanical - Temperature: 72 deg F +/- 2 deg F
Humidity: ambient
Exhaust: 100% (VAV)
Air change rate: 6/hour occupied;
4 per hour unoccupied
Equipment heat gain: 50 btuh/sf
5' Chemical Fume Hood: 600 c.f.m. (VAV)

Structural - Vibration attenuation: 4,000 microinches per second or less as defined by AISC #11

Plumbing - Hot/Cold water at sinks
Pure water at sinks
Domestic water at safety shower/eyewash
Natural gas, vac, air at benches
Nitrogen gas at benches
Drain at eyewash
Floor drain at safety shower
Emer gas shut-off
Argon, CO2, O2, H2, acetylene cylinder gases

Electrical - 115v outlets at all benches
Fourplex at 4' on center at perimeter
Standby power at equipment space
Wired and wireless data
Lighting: direct/indirect at 500 Lux

Contractor Furnished Equipment - Wood casework (bamboo veneer over plywood/MDF substrate)
Epoxy tops and sinks (black epoxy tops)
Faucets and fittings (satin chrome)
Mobile instrument benches
(2) chemical fume hoods (VAV)
Fire ext. cabinet

College Furnished Equipment - Chairs, stools
Benchtop analytical instruments
Scientific equipment
Gas chromatographs
Mass Spectrometers

Illustration - Instrument Room

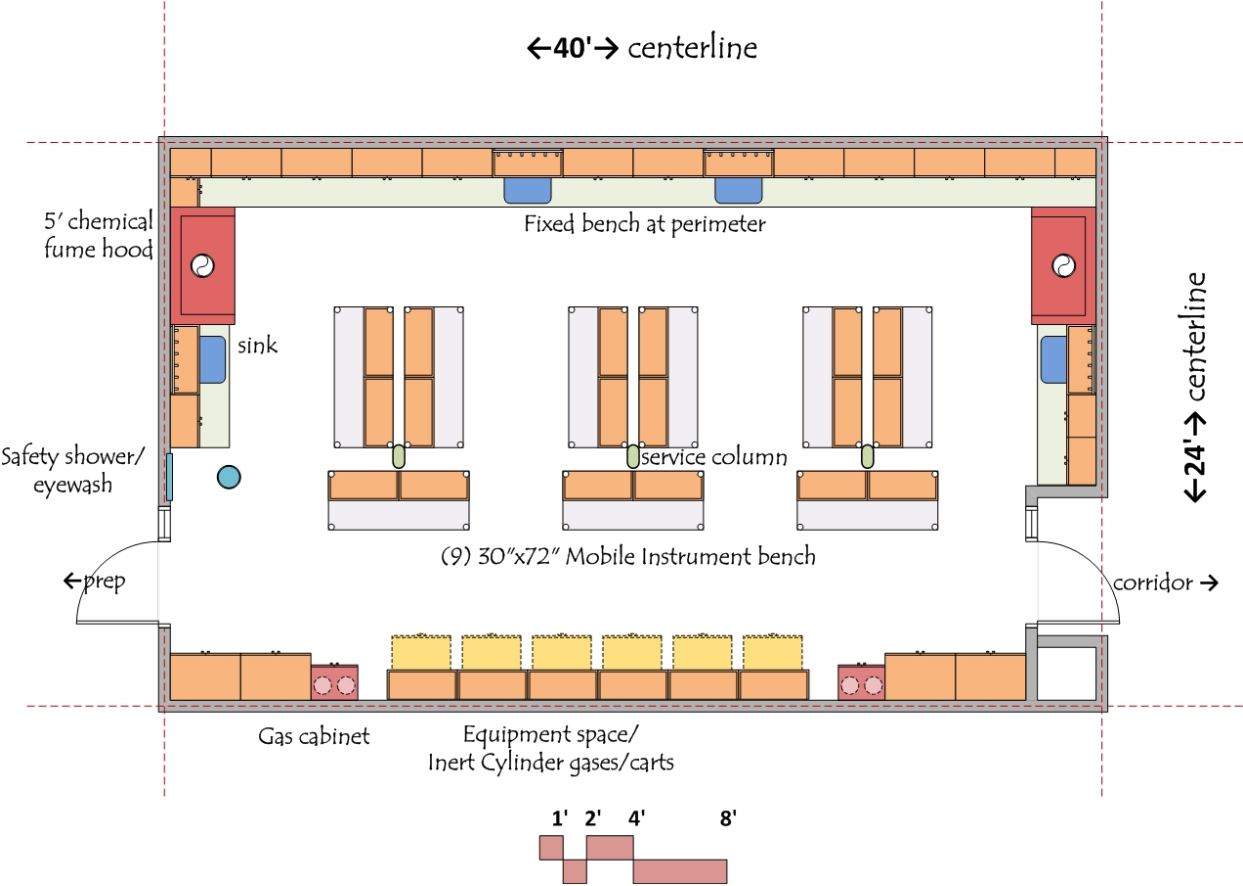

Area Name - Balance Room

Space Number - B10

ASF - 456 (face of wall)

Date - July 11, 2014

No. Required - 1

Information received from - Physical Science Faculty

General Description - Balances for general chemistry labs

Adjacencies - Direct access general chemistry labs
Direct access or near prep room
Locate on top floor

Architecture - Occupancy: B
Planning dimensions: 20'x25' (centerline of wall)
Floor: sealed concrete or VCT
Walls: gypsum board with enamel paint
Ceiling: acoustic tile at 9' minimum
Doors: 36x80 with window
Natural daylight: not required
Acoustic attenuation: NC 40 or less
Security: Card key or punch key access

Mechanical - Temperature: 72 deg F +/- 2 deg F
Humidity: ambient
Exhaust: 100% (VAV)
Air change rate: 6/hour occupied;
4 per hour unoccupied
Equipment heat gain: 50 btuh/sf

Structural - Vibration attenuation: 2,000 microinches per second or less as defined by AISC #11

Plumbing - Domestic water at safety shower/eyewash
Natural gas, vac, air at benches
Emer gas shut-off

Electrical - 115v outlets at all benches
Fourplex at 4' on center at perimeter
Standby power at equipment space
Wired and wireless data
Lighting: direct/indirect at 500 Lux

Contractor Furnished Equipment - Wood casework (bamboo veneer over plywood/MDF substrate)
Epoxy tops and sinks (black epoxy tops)
Faucets and fittings (satin chrome)
Mobile lab tables

College Furnished Equipment - Chairs, stools
Scientific equipment
(20) analytical balances

Illustration - Balance Room

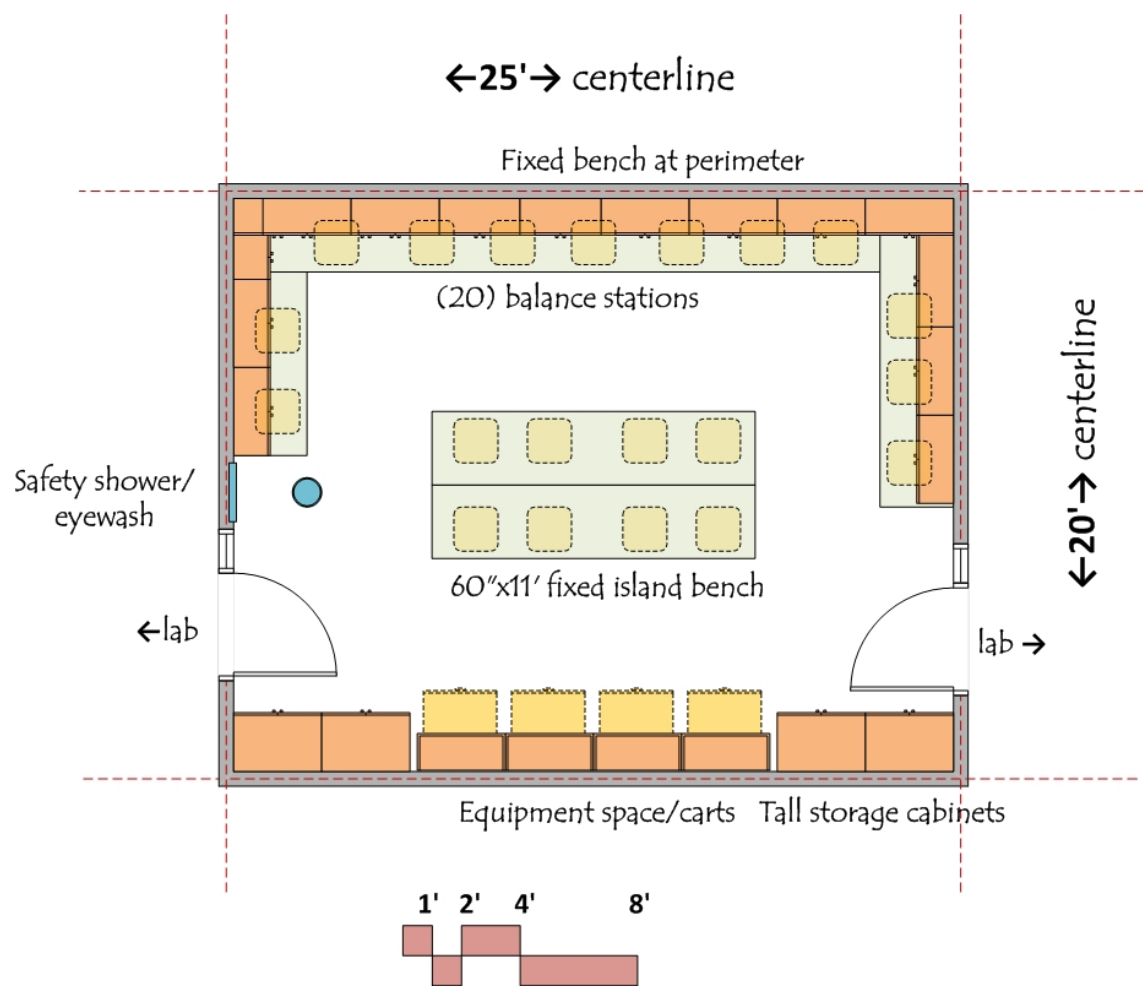

Area Name - Chemical Store Room

Space Number - B11

ASF - 456 (face of wall)

Date - July 11, 2014

No. Required - 1

Information received from - Physical Science Faculty

General Description - Provides storage for chemicals

Adjacencies - Direct access to Chemistry Prep/Stock
Locate on top floor

Architecture - Occupancy: B
Planning dimensions: 20'x25' (centerline of wall)
Floor: sealed concrete or VCT
Walls: gypsum board with enamel paint
Ceiling: acoustic tile at 9' minimum
Doors: 36x80 with window at corridor; 36x80 dutch door at prep room
Natural daylight: none required
Acoustic attenuation: NC 40 or less
Security: Card key or punch key access

Mechanical - Temperature: 72 deg F +/- 2 deg F
Humidity: ambient
Exhaust: 100% (VAV)
Air change rate: 6/hour 24/7/365
50 cfm exhaust at each corrosive cabinet

Structural - Vibration attenuation: 4,000 microinches per second or less as defined by AISC #11

Plumbing - Domestic water at safety shower/eyewash
Drain at eyewash
Floor drain at safety shower

Electrical - 115v outlets at all benches
Fourplex at 4' on center at perimeter
wireless data
Lighting: direct/indirect at 500 Lux

Contractor Furnished Equipment - Corrosive storage cabinets (vented)
Flammable storage cabinets (not vented)
4' chemical fume hood (VAV)
Canopy hood above refrigerator

College Furnished Equipment - Chemical storage containers
Explosion proof refrigerator

Illustration - Chemical Store Room

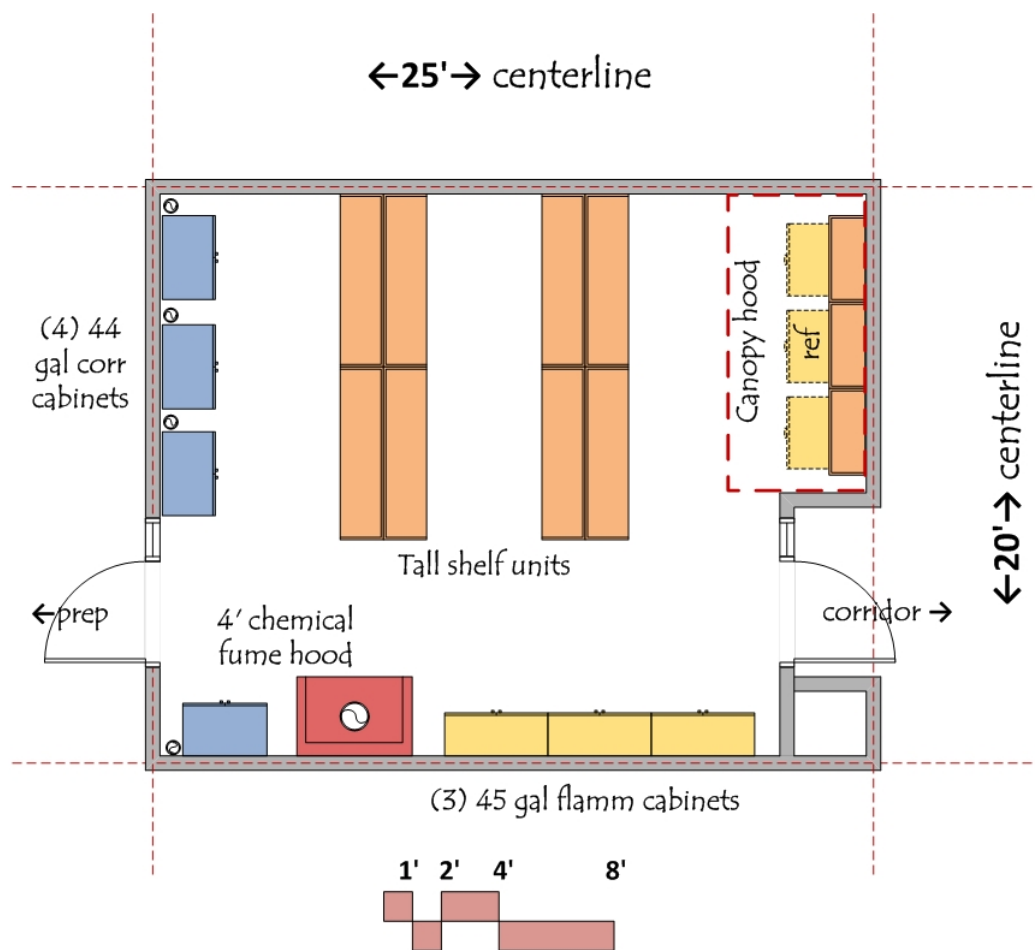

Area Name - Telescope Storage

Space Number - B12

ASF - 154 (face of wall)

Date - July 11, 2014

No. Required - 1

Information received from - Physical Science Faculty

General Description - Provides storage for astronomy telescopes**Adjacencies** - Near Astronomy viewing platform at top floor**Architecture** - Occupancy: B
Planning dimensions: 15'x15' (centerline of wall)
Floor: sealed concrete
Walls: gypsum board with enamel paint
Ceiling: acoustic tile at 9' minimum
Doors: 36x80 with window at corridor
Natural daylight: none required
Security: Card key or punch key access**Mechanical** - Temperature: 72 deg F +/- 2 deg F
Humidity: ambient**Structural** - Vibration attenuation: 4,000 microinches per second or less as defined by AISC #11**Plumbing** - None**Electrical** - 115v Fourplex at perimeter
wireless data
Lighting: direct/indirect at 500 Lux**Contractor
Furnished
Equipment** - Telescope storage cabinets**College
Furnished
Equipment** - Telescopes

Illustration - Telescope Store Room

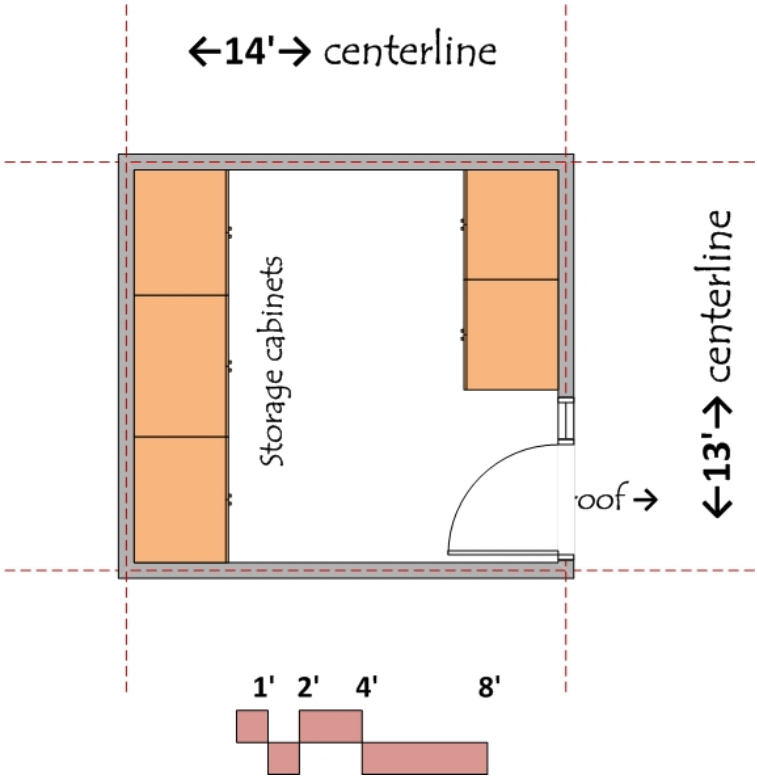

Area Name - Astronomy Viewing Platform

Space Number - B13

ASF - 2574 (face of wall)

Date - July 11 2014

No. Required - 1

Information received from - Physical Science Faculty

General Description - Telescope platform with 16 pillars, being polar-aligned to true north with mounting bolts embedded in their tops for attaching the telescope equatorial wedges.

Adjacencies - Maintain telescope viewing angle down to 10 degrees above the horizon minimum
Telescope Storage
Locate at top floor

Architecture - Elevator access required
Stair access required
The greatest possible all-sky view should be maintained.

Mechanical - Ensure separation from mechanically induced vibration

Structural - Meet telescope vibration performance criteria, isolated from surrounding deck
Orient bolts at each pier to true North, within accuracy of 2 archminutes.
Observatory pad must be coated to reduce radiated and reflected heat.

Plumbing - None

Electrical - All lighting to be low cutoff angle
No white light pollution in viewing zone; pathway and pillar lighting should be red color to avoid loss of night vision. Baffles should be over each light source to direct illumination downwards.
White light is needed for social event, but should be on separate circuits from the red lights.
Power and data connections are required at each pillar.
(1) Quadplex power & (1) Data J-Box each pier - centered on north side
Each pillar will require an RS-232 data connection to a PC. Power and data should be within a lockable cover for security.

Contractor Furnished Equipment - N/A

College Furnished Equipment - Telescopes

Illustration - Astronomy Viewing Platform

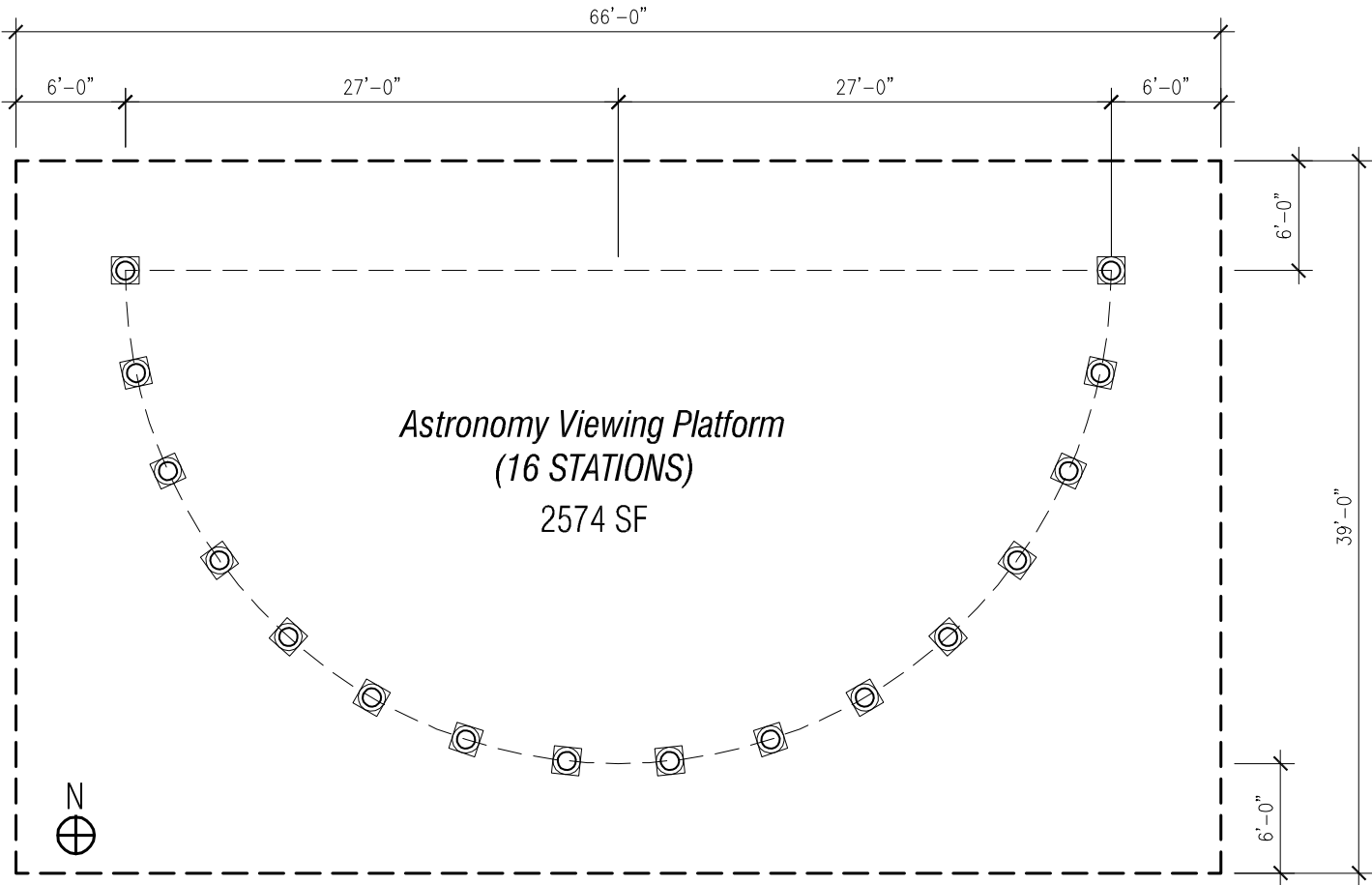

Area Name - Classroom A

Space Number - C1

ASF - 2,150 SF

Date - June 09, 2014

No. Required - 1

Information received from - Core/BUG Team

General Description - Lecture classroom (96 students)
District classroom standards

Adjacencies - Faculty Offices

Architecture - Ceiling: acoustic ceiling tile, 10' clear
Walls: Painted gypsum board, windows, operable partition
Floor: Carpet w/ rubber base

Mechanical - 68-75 ° F \pm 2 ° F
Re-circulated air, HVAC

Structural - N/A**Plumbing** - None Required

Electrical - Dual light level in front of classroom
Future smart board
AV infrastructure
110v duplex outlets/data junction boxes
Wireless data connection
Indirect fluorescent lighting, 50 f.c.

College Furnished Equipment - Manual projection screen/digital projection system
Marker board, 20 L.F.
Lectern with side table and A/V connection
Tables, chairs, trash containers

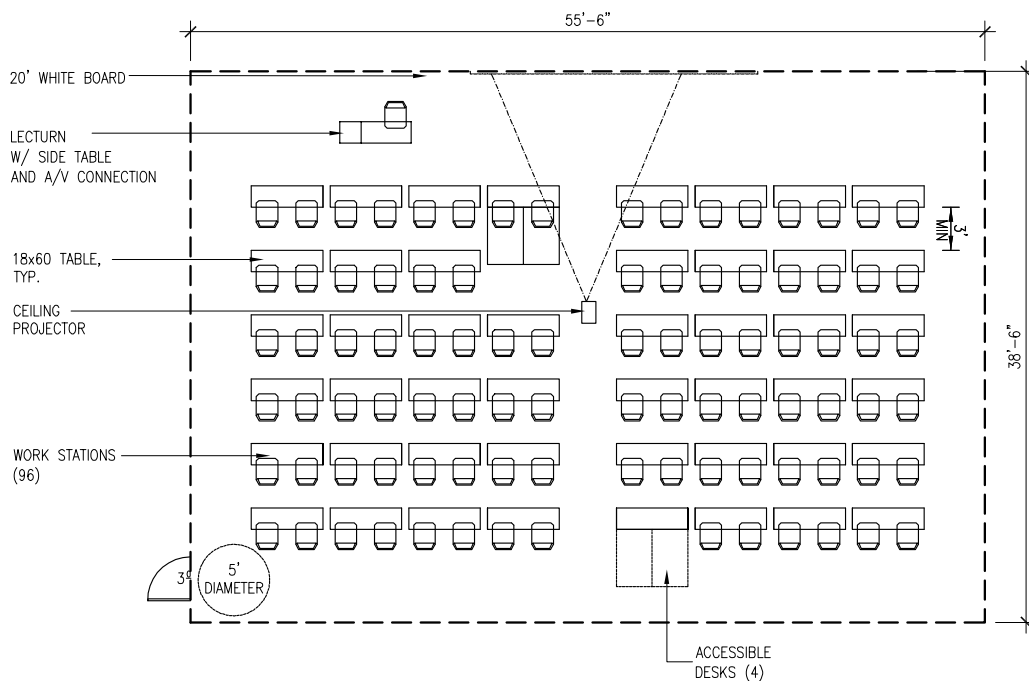
Illustration

Area Name - Classroom B

Space Number - C2

ASF - 1,600 SF

Date - June 09, 2014

No. Required - 1

Information received from - Core/BUG Team

General Description - Lecture classroom (64 students)
District classroom standards

Adjacencies - Faculty Offices

Architecture - Ceiling: acoustic ceiling tile, 10' clear
Walls: Painted gypsum board, windows
Floor: Carpet w/ rubber base

Mechanical - 68-75 ° F \pm 2 ° F
Re-circulated air, HVAC

Structural - N/A

Plumbing - None Required

Electrical - Dual light level in front of classroom
Future smart board
AV infrastructure
110v duplex outlets/data junction boxes
Wireless data connection
Indirect fluorescent lighting, 50 f.c.

College Furnished Equipment - Manual projection screen/digital projection system
Marker board, 20 L.F.
Lectern with side table and A/V connection
Tables, chairs, trash containers

Illustration

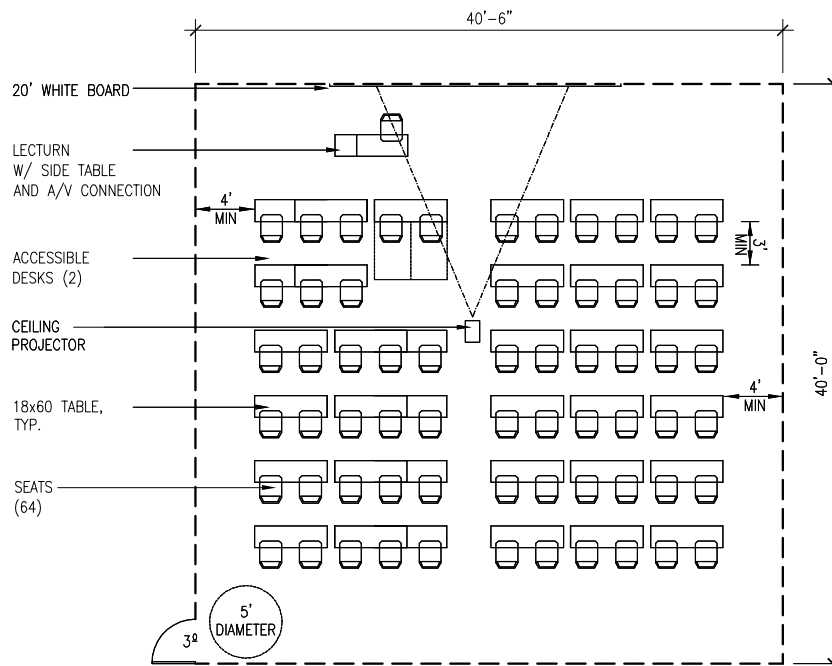

Area Name - Classroom C

Space Number - C3

ASF - 977 SF

Date - June 09, 2014

No. Required - 3

Information received from - Core/BUG Team

General Description - Lecture classroom (48 students)
District classroom standards

Adjacencies - Faculty Offices

Architecture - Ceiling: acoustic ceiling tile, 10' clear
Walls: Painted gypsum board, windows
Floor: Carpet w/ rubber base

Mechanical - 68-75 ° F \pm 2 ° F
Re-circulated air, HVAC

Structural - N/A

Plumbing - None Required

Electrical - Dual light level in front of classroom
Future smart board
AV infrastructure
110v duplex outlets/data junction boxes
Wireless data connection
Indirect fluorescent lighting, 50 f.c.

College Furnished Equipment - Manual projection screen/digital projection system
Marker board, 20 L.F.
Lectern with side table and A/V connection
Tables, chairs, trash containers

Illustration

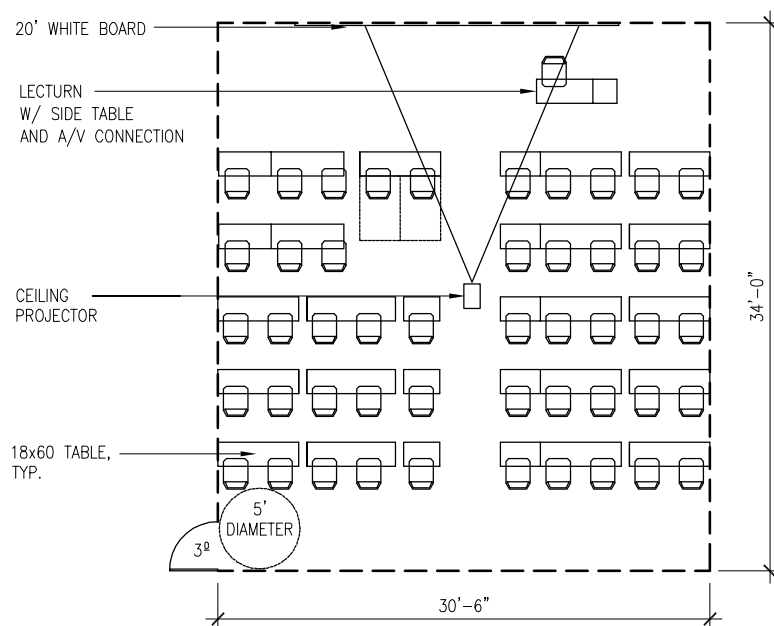

Area Name - Classroom D

Space Number - C4

ASF - 977 SF

Date - June 09 2014

No. Required - 13

Information received from - Core/BUG Team

General Description - Lecture classroom (42 students)
District classroom standards

Adjacencies - Faculty Offices

Architecture - Ceiling: acoustic ceiling tile, 10' clear
Walls: Painted gypsum board, windows
Floor: Carpet w/ rubber base

Mechanical - 68-75 ° F \pm 2 ° F
Re-circulated air, HVAC

Structural - N/A

Plumbing - None Required

Electrical - Dual light level in front of classroom
Future smart board
AV infrastructure
110v duplex outlets/data junction boxes
Wireless data connection
Indirect fluorescent lighting, 50 f.c.

College Furnished Equipment - Manual projection screen/digital projection system
Marker board, 20 L.F.
Lectern with side table and A/V connection
Tables, chairs, trash containers

Illustration

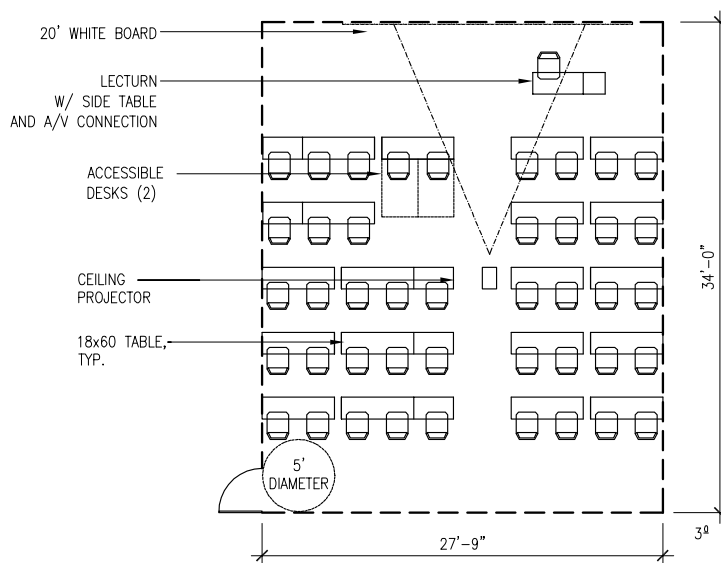

Area Name - Computer Classroom

Space Number - C5

ASF - 1,000 SF

Date - June 09, 2014

No. Required - 3

Information received from - Core/BUG Team

General Description - Lecture classroom (45 students)
District classroom standards

Adjacencies - Faculty Offices
Classrooms
Open Computer Lab
Math Center

Architecture - Ceiling: acoustic ceiling tile, 10' clear
Walls: Painted gypsum board, windows
Floor: Carpet w/ rubber base
Partition (movable)

Mechanical - 68-75 ° F \pm 2 ° F
Re-circulated air, HVAC

Structural - N/A

Plumbing - None Required

Electrical - Dual light level in front of classroom
Future smart board
AV infrastructure
110v duplex outlets/data junction boxes
Wireless data connection
Indirect fluorescent lighting, 50 f.c.

College Furnished Equipment - Manual projection screen/digital projection system
Marker board, 20 L.F.
Lectern with side table and A/V connection
Tables, chairs, trash containers
Workstations

Illustration

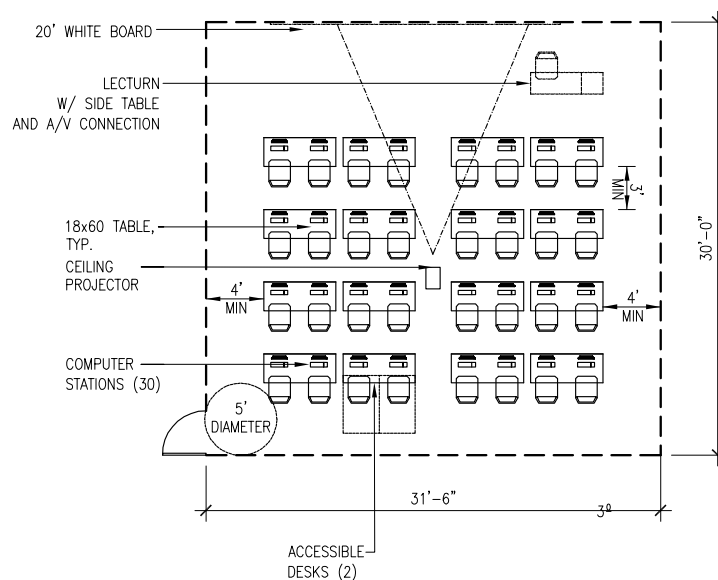

Area Name - Tutor Counter

Space Number - D1

ASF - 240 SF

Date - June 09, 2014

No. Required - 1

Information received from - Core Team/Faculty

General Description - Tutoring staff reception & work counter

Adjacencies - Open Study
Faculty Work
Open Computer
Group Study

Architecture - Ceiling: Acoustic tile, 9' clear
Walls: Painted gypsum board, windows
Floor: Carpet with rubber base

Mechanical - 68-75 ° F \pm 2 ° F
Re-circulated air, HVAC

Structural - N/A

Plumbing - None Required

Electrical - 110v duplex outlets
Data junction box
Wireless data connection
Indirect fluorescent lighting, 60 f.c.

College Furnished Equipment - Digital projection system
Tables, chairs, trash containers

Illustration

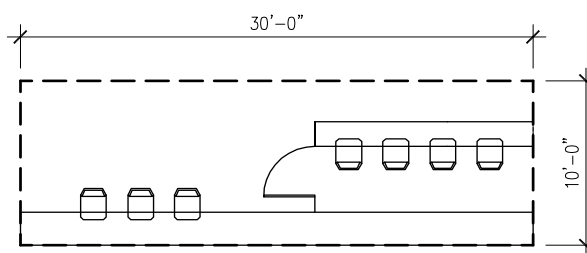

Area Name - Open Study

Space Number - D2

ASF - 800 SF

Date - June 09, 2014

No. Required - 2

Information received from - Core Team/Faculty

General Description - Tutoring staff reception & work counter
View to exterior
Outdoor studying (if possible)

Adjacencies - Tutoring Counter
Open Computer
Group Study

Architecture - Ceiling: Acoustic tile, 9' clear
Walls: Painted gypsum board, windows
Floor: Carpet with rubber base

Mechanical - 68-75 ° F \pm 2 ° F
Re-circulated air, HVAC

Structural - N/A

Plumbing - None Required

Electrical - 110v duplex outlets
Data junction box
Writable work wall surfaces
Wireless data connection
Indirect fluorescent lighting, 60 f.c.

College Furnished Equipment - Shared Work Table
Marker board, 20 L.F.
Tables, chairs, trash containers

Illustration

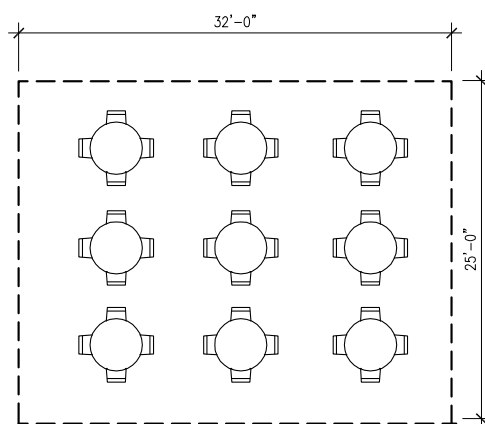

Area Name - Open Computer

Space Number - D3

ASF - 1,000 SF

Date - June 09, 2014

No. Required - 1

Information received from - Core Team/Faculty

General Description - Unassigned computer work stations
View to Computer Classroom
Seating with open pods
30 students

Adjacencies - Tutor Counter
Faculty Work
Open Study
Group Study
Computer Classroom

Architecture - Ceiling: Acoustic tile, 9' clear
Walls: Painted gypsum board, windows
Floor: Carpet with rubber base

Mechanical - 68-75 ° F \pm 2 ° F
Re-circulated air, HVAC

Structural - N/A

Plumbing - None Required

Electrical - 110v duplex outlets
Data junction box
Writable work wall surfaces
Wireless data connection
Indirect fluorescent lighting, 60 f.c.

College Furnished Equipment - Work Stations
Marker board, 20 L.F.
Tables, chairs, trash containers

Illustration

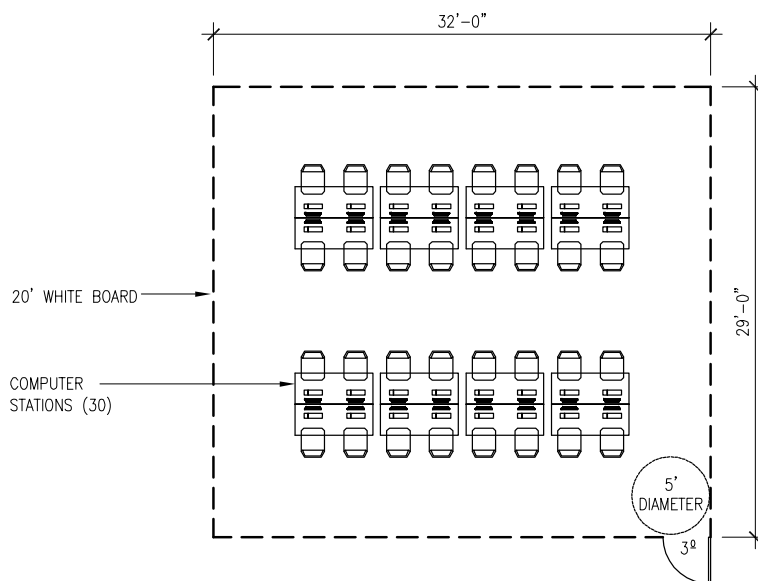

Area Name - Group Study - Small

Space Number - D4

ASF - 100 SF

Date - June 09, 2014

No. Required - 4

Information received from - Core Team/Faculty

General Description - Unassigned group study space
Viewable from Open Study area

Adjacencies - Tutor Counter
Faculty Work
Open Study
Group Study

Architecture - Ceiling: Acoustic tile, 9' clear
Walls: Painted gypsum board, windows
Floor: Carpet with rubber base

Mechanical - 68-75 ° F \pm 2 ° F
Re-circulated air, HVAC

Structural - N/A

Plumbing - None Required

Electrical - 110v duplex outlets
Data junction box
Wireless data connection
Indirect fluorescent lighting, 60 f.c.

College Furnished Equipment - Shared Work Table
Marker board, 20 L.F.
Tables, chairs, trash containers

Illustration

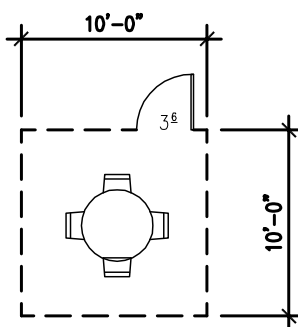

Area Name - Group Study - Large

Space Number - D5

ASF - 450 SF

Date - June 09, 2014

No. Required - 1

Information received from - Core Team/Faculty

General Description - Unassigned group study space
Meeting/Testing (multipurpose)

Adjacencies - Tutor Counter
Faculty Work
Open Study
Group Study

Architecture - Ceiling: Acoustic tile, 9' clear
Walls: Painted gypsum board, windows
Floor: Carpet with rubber base

Mechanical - 68-75 ° F \pm 2 ° F
Re-circulated air, HVAC

Structural - N/A

Plumbing - None Required

Electrical - 110v duplex outlets
Data junction box
AV infrastructure
Wireless data connection
Indirect fluorescent lighting, 60 f.c.

College Furnished Equipment - Shared Work Table
Manual projection screen
Digital projection system
Marker board, 20 L.F.
Tables, chairs, trash containers

Illustration

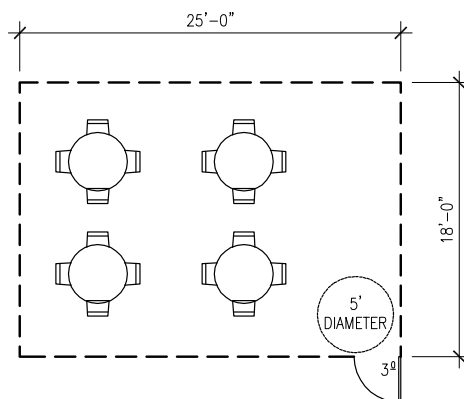

Area Name - Office / Storage

Space Number - D6

ASF - 450 SF

Date - June 09, 2014

No. Required - 1

Information received from - Core Team/Faculty

General Description - A general use area for Faculty and support staff

Adjacencies - Group Study
Open Computer

Architecture - Ceiling: Acoustic tile, 9' clear
Walls: Painted gypsum board, windows
Floor: Carpet with rubber base

Mechanical - 68-75 ° F \pm 2 ° F
Re-circulated air, HVAC

Structural - N/A

Plumbing - None Required

Electrical - 110v duplex outlets
Data junction box
Wireless data connection
Indirect fluorescent lighting, 60 f.c.

College Furnished Equipment - Office Systems Furniture
Computer station
Copiers, Printers, and Fax Machines
Table, Chairs
Trash Bin

Illustration

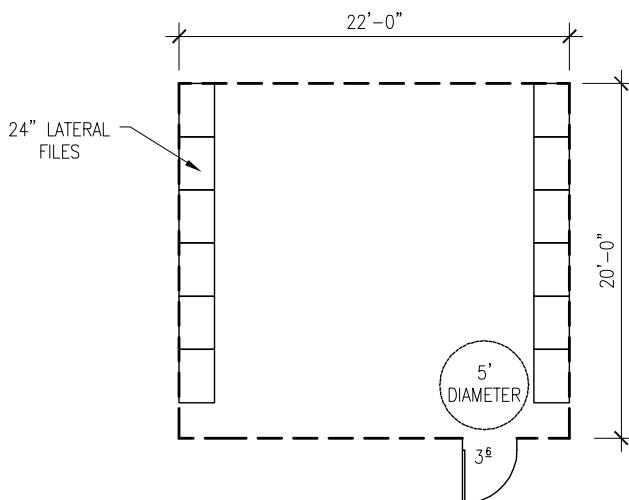

Area Name - MESA: Director Office, Clerical, Open work/study, 8 seat conference room

Space Number - D7

ASF - 1300 SF

Date - June 09, 2014

No. Required - 1

Information received from - Core Team/Faculty

General Description - Office & support space for faculty/staff offices, providing large work areas as well as printing, copying and faxing equipment

Adjacencies - Office / Storage
Group Study

Architecture - Ceiling: Acoustic tile, 9' clear
Walls: Painted gypsum board, windows
Floor: Carpet with rubber base

Mechanical - 68-75 ° F \pm 2 ° F
Re-circulated air, HVAC

Structural - N/A

Plumbing - None Required

Electrical - 110v duplex outlets
Data junction box
Wireless data connection
Indirect fluorescent lighting, 60 f.c.

College Furnished Equipment - Office Systems Furniture
Computer Station
Shared Work Table
Copiers, Printers, and Fax Machines
Table, Chairs
Trash Bin

Illustration

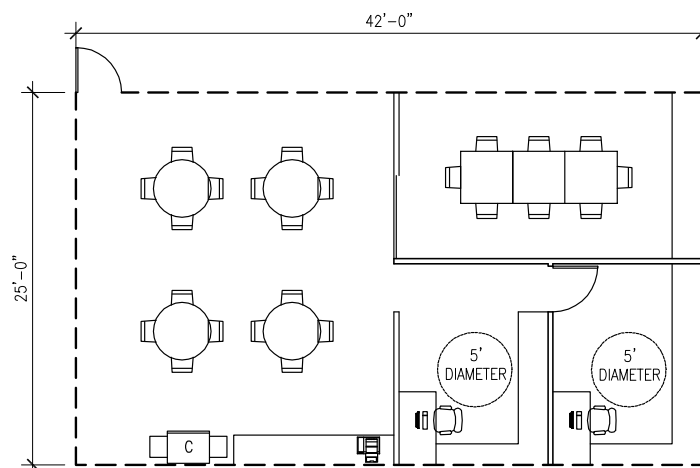

Area Name - Faculty Office (Private)

Space Number - E1

ASF - 90 SF

Date - June 09 2014

No. Required - 45

Information received from - Core/BUG Team

General Description - Private faculty office

Adjacencies - Classroom
Laboratory

Architecture - Ceiling: Acoustic tile, 9' clear
Walls: Painted gypsum board, windows
Floor: Carpet with rubber base

Mechanical - 68-75 ° F \pm 2 ° F
Re-circulated air, HVAC

Structural - N/A**Plumbing** - None Required

Electrical - 110v duplex outlets
Data junction box
Wireless data connection
Indirect fluorescent lighting, 60 f.c.

**College
Furnished
Equipment** - Office Systems Furniture
Computer Station
Trash Bin

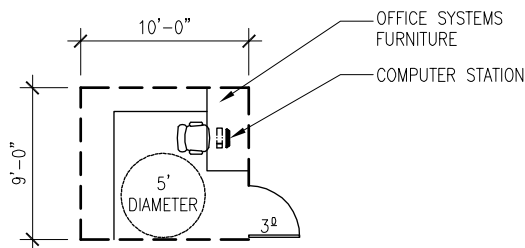
Illustration

Area Name - Dean's Office

Space Number - F1

ASF - 300

Date - June 09, 2014

No. Required - 1

Information
received from - Core TeamGeneral
Description - Office for the DeanAdjacencies - Reception/Waiting/Copy/Mail
Faculty Work

Architecture - Ceiling: Acoustic tile, 9' clear
Walls: Painted gypsum board, windows
Floor: Carpet with rubber base

Mechanical - 68-75 ° F \pm 2 ° F
Re-circulated air, HVAC

Structural - N/A**Plumbing** - None Required

Electrical - 110v duplex outlets
Data junction box
Wireless data connection
Indirect fluorescent lighting, 60 f.c.

**College
Furnished
Equipment** - Office Systems Furniture
Computer Station
Table, Chairs
Trash Bin

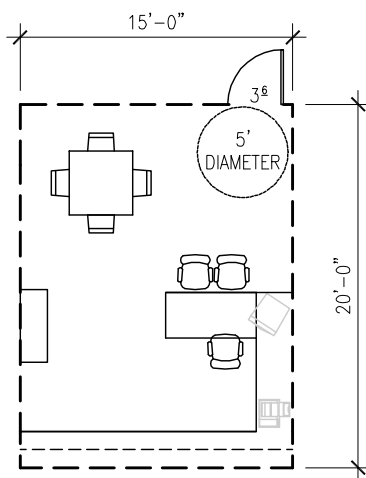
Illustration

Area Name - Reception/Waiting/Copy/Mail

Space Number - F2

ASF - 500 SF

Date - June 09, 2014

No. Required - 1

Information received from - Core Team/Faculty

General Description - Support space for faculty/staff offices, providing large work areas as well as printing, copying and faxing equipment

Adjacencies - Dean's Office
Faculty Work

Architecture - Ceiling: Acoustic tile, 9' clear
Walls: Painted gypsum board, windows
Floor: Carpet with rubber base

Mechanical - 68-75 ° F \pm 2 ° F
Re-circulated air, HVAC

Structural - N/A

Plumbing - None Required

Electrical - 110v duplex outlets
Data junction box
Wireless data connection
Indirect fluorescent lighting, 60 f.c.

College Furnished Equipment - Office Systems Furniture
Computer Station
Shared Work Table
Copiers, Printers, and Fax Machines
Table, Chairs
Trash Bin

Illustration

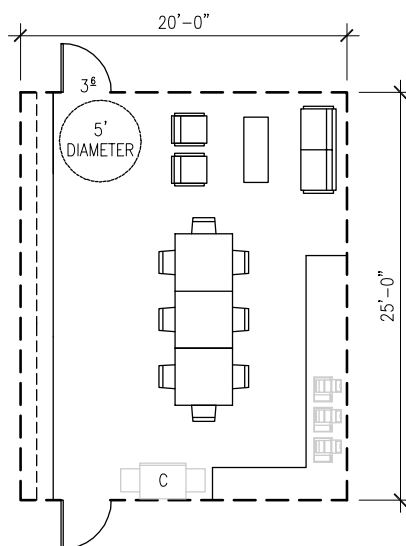

Area Name - Storage

Space Number - F3

ASF - 250 SF

Date - June 09, 2014

No. Required - 1

Information received from - Core Team/Faculty

General Description - A general use area for Faculty and support staff
 (4) scantrons
 3' wide shelving
 storage for manipulative open bins (8')
 (10) 3 drawers high (40 @ 18")
 (4) work tables (36" x 60")

Adjacencies - Dean's Office
 Faculty Work
 Reception
 Close to Math Center
 Accessible to Math Coordinator's Office

Architecture - Ceiling: Acoustic tile, 9' clear
 Walls: Painted gypsum board, windows
 Floor: Carpet with rubber base

Mechanical - 68-75 ° F \pm 2 ° F
 Re-circulated air, HVAC

Structural - N/A

Plumbing - None Required

Electrical - Indirect fluorescent lighting, 50 f.c.

**College
 Furnished
 Equipment** -

Illustration

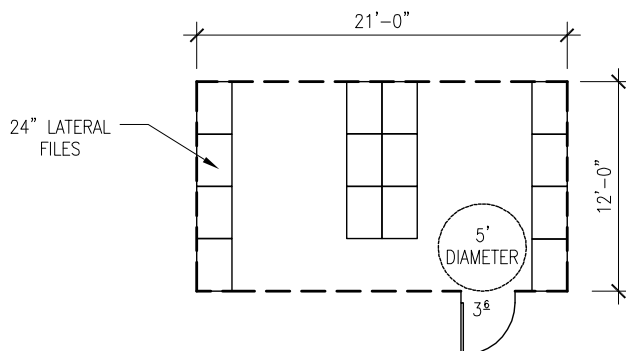

Area Name - Faculty Work

Space Number - F4

ASF - 350 SF

Date - June 09, 2014

No. Required - 1

Information received from - Core Team/Faculty

General Description - General work space with computer stations for faculty and adjunct faculty

Adjacencies - Dean's Office
Reception
Offices

Architecture - Ceiling: Acoustic tile, 9' clear
Walls: Painted gypsum board, windows
Floor: Carpet with rubber base

Mechanical - 68-75 ° F \pm 2 ° F
Re-circulated air, HVAC

Structural - N/A

Plumbing - None Required

Electrical - 110v duplex outlets
Data junction box
Wireless data connection
Indirect fluorescent lighting, 60 f.c.

College Furnished Equipment - Office Systems Furniture
4 scantrons
4 computers
Trash Bin
copier/scanner
open shelves

Illustration

