



Architect:
Marlene Imirzian & Associates Architects

Construction Manager @ Risk:



MATH AND SCIENCE BUILDING

A new Math and Science building will replace existing classrooms, laboratories, and lecture hall spaces currently housed in multiple buildings over 50 years old. This new and advanced two-story facility is a corner stone of the Science, Technology, and Mathematics programs, including Biology, Chemistry, Physics, Geology, and Mathematics. The building is designed for certification as a Leadership in Energy & Environmental Design (LEED) Silver project by the U. S. Green Building Council. Sustainability features include drought tolerant landscaping and a large belowground cistern for collecting building condensate water and rainwater for use in irrigation.

The site for this new building is where the Pool, Physical Education, and Gymnasium facilities were formerly located. These original campus facilities have been relocated to the new Wellness and Aquatics Complex.

- Est. Size: 103,029 ASF
- Faculty/Administration Office Space
- Rooftop Telescope Platform
- Classrooms and Laboratories
- Biology Green House & Pond
- MESA Achievement Program

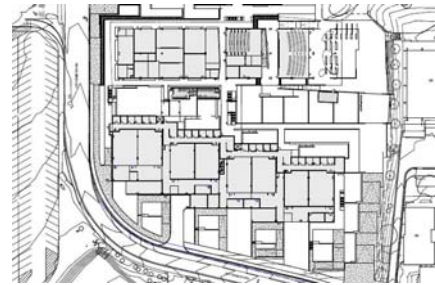

Project Budget: 88.6

M
 (in Millions)

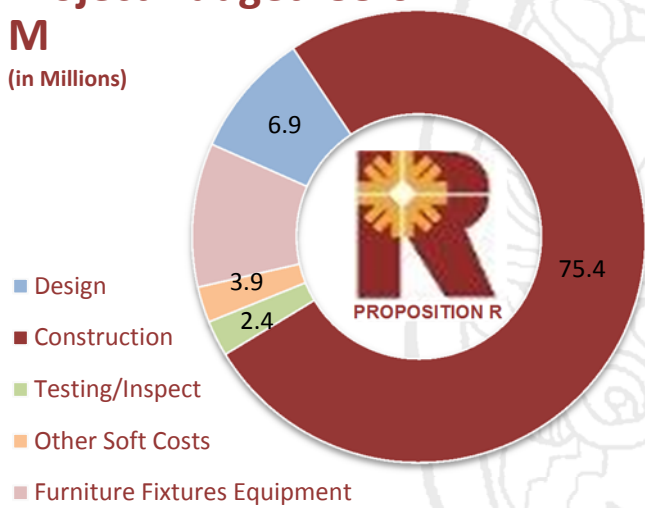

Project Timeline

